

# **SNIJRINGKOPPELINGEN / RACCORDS A BAGUE COUPANTE**

## **INHOUDSTAFEL / TABLE DES MATIERES**

|   |    |
|---|----|
| INHOUDSTAFEL / TABLE DES MATIERES.....                                | 1  |
| AANSLUITINGEN EN DRUK / RACCORD ET PRESSION.....                      | 3  |
| DRUKBEREIK / PRESSION MAX.....  | 4  |
| LASKOPPELING / RACCORD A SOUDER.....                                  | 5  |
| LASKOPPELING / RACCORD A SOUDER.....                                  | 6  |
| RICHTBARE KOPPELING MET METR. BUITENDRAAD.....                        | 7  |
| RACCORD ORIENTABLE AVEC FILET EXTER. METRIQUE.....                    | 7  |
| RICHTBARE KOPPELINGEN MET NPT BUITENDRAAD.....                        | 8  |
| RACCORD ORIENTABLE AVEC FILET EXTERIEUR NPT.....                      | 8  |
| RICHTBARE KOPPELING MET BSP BUITENDRAAD.....                          | 9  |
| RACCORD ORIENTABLE AVEC FILET EXTERIEUR BSP.....                      | 9  |
| RICHTBARE KOPPELING MET BSP BUITENDRAAD.....                          | 10 |
| RACCORD ORIENTABLE AVEC FILET EXTERIEUR BSP.....                      | 10 |
| KOPPELING VOOR MANOMETERS MET VLAKE ZITTING.....                      | 13 |
| RACCORD POUR MANOMETRE AVEC SIEGE PLAT.....                           | 13 |
| BSP REDUCTIES / REDUCTIONS BSP.....                                   | 14 |
| KOPPELING MET METRISCHE BINNENDRAAD.....                              | 17 |
| RACCORD AVEC FILET METRIQUE INTERIEUR.....                            | 17 |
| KOPPELING MET BSP BINNENDRAAD.....                                    | 18 |
| RACCORD AVEC FILET INTERIEUR BSP.....                                 | 18 |
| KOPPELINGEN MET FLENZEN - 3000PSI.....                                | 19 |
| RACCORDS A BRIDES – 3000PSI.....                                      | 19 |
| KOPPELINGEN MET FLENZEN – 6000PSI.....                                | 20 |
| RACCORDS A BRIDES – 6000PSI.....                                      | 20 |
| KOPPELING MET METRISCHE BUITENDRAAD.....                              | 21 |
| RACCORD AVEC FILET METRIQUE EXTERIEUR.....                            | 21 |
| KOPPELING MET CONISCHE METR. BUITENDRAAD.....                         | 22 |
| RACCORD AVEC FILET METRIQUE CONIQUE EXT.....                          | 22 |
| KOPPELING MET NPT BUITENDRAAD.....                                    | 23 |
| RACCORD AVEC FILET EXTERIEUR NPT.....                                 | 23 |
| KOPPELING MET ORFS DRAAD.....   | 24 |
| RACCORD AVEC FILET ORFS.....  | 24 |
| KOPPELING MET BSP BUITENDRAAD / RACCORD AVEC FILET EXTERIEUR BSP..... | 25 |
| KOPPELING MET BSP BUITENDRAAD / RACCORD AVEC FILET EXTERIEUR BSP..... | 26 |
| KOPPELING MET CONISCHE BSP BUITENDRAAD.....                           | 27 |
| RACCORD AVEC FILET EXTERIEUR BSP CONIQUE.....                         | 27 |
| KOPPELING MET SAE BUITENDRAAD.....                                    | 28 |
| RACCORD AVEC FILET EXTERIEUR SAE.....                                 | 28 |
| KOPPELING VOOR SCHOTDOORVOER.....                                     | 29 |
| RACCORD PASSE-CLOISON.....  | 29 |
| SCHOTDOORVOER MET BSP BUITENDRAAD.....                                | 30 |
| RACCORD PASSE-CLOISON AVEC FILET EXTERIEUR BSP.....                   | 30 |
| RECHTE VERBINDING / UNION DROIT.....                                  | 33 |
| RECHTE VERBINDING / UNION DROIT.....                                  | 34 |
| REDUCTIEKOPPELING / REDUCTION.....                                    | 35 |
| KRUISKOPPELING / CROISILLONS.....                                     | 36 |
| LORF LASKOPPELING / RACCORD LORF A SOUDER.....                        | 37 |
| MOER VOOR LORF LASKOPPELING / ECROU POUR RACCORD LORF A SOUDER.....   | 37 |
| "T" KOPPELING / RACCORD EN "T".....                                   | 38 |
| "T" KOPPELING MET CONISCHE BSP BUITENDRAAD.....                       | 39 |
| RACCORD EN "T" AVEC FILET EXTER. BSP CONIQUE.....                     | 39 |
| MOER / ECROU.....   | 40 |
| MOER VOOR BUIS SAE 37° / ECROU POUR TUBE SAE 37°.....                 | 41 |

Standaard verzinkt, ook leverbaar in RVS – standard zingué, aussi livrable en inox

# SNIJRINGKOPPELINGEN/RACCORDS A BAGUE COUPANTE

## INHOUDSTAFEL/TABLE DES MATIERES

|  |    |
|--|----|
| MANOMETERKOPPELING MET BSP BINNENDRAAD .....   | 42 |
| RACCORD POUR MANOMETRE AVEC FILET INTER. BSP .....                                       | 42 |
| DICHTINGSRING .....  | 42 |
| O-RING .....   | 42 |
| KOPPELING MET METRISCHE BINNENDRAAD RACCORD AVEC FILET INTERIEUR METRIQUE .....          | 43 |
| KOPPELING 45 ° MET METRISCHE BINNENDRAAD RACCORD 45° AVEC FILET INTERIEUR METRIQUE ..... | 44 |
| KOPPELING 90 ° MET METRISCHE BINNENDRAAD RACCORD 90° AVEC FILET INTERIEUR METRIQUE ..... | 45 |
| STEUNRING VOOR BUIS SAE 37° / BAGUE DE RENFORT POUR SAE 37° .....                        | 49 |
| SNIJRINGEN / BAGUES COUPANTES .....  | 50 |
| BANJOKOPPELING MET METRISCHE SCHROEFDRAAD .....  | 51 |
| RACCORD BANJO AVEC FILET METRIQUE .....  | 51 |
| BANJOKOPPELING MET BSP DRAAD .....   | 52 |
| RACCORD BANJO AVEC FILET BSP .....   | 52 |
| "T" KOPPELING MET METRISCHE DRAAD .....  | 53 |
| RACCORD EN "T" AVEC FILET METRIQUE .....   | 53 |
| "T" KOPPELING MET BSP DRAAD / RACCORD EN "T" AVEC FILET BSP .....                        | 54 |
| "T" KOPPELING MET CONISCHE BSP DRAAD .....   | 55 |
| RACCORD EN "T" AVEC FILET BSP CONIQUE .....  | 55 |
| "T" VERBINDING / UNION EN "T" .....  | 56 |
| STOP VOOR CONE 24° / BOUCHON CÔNE 24° .....  | 57 |
| STOP MET BSP DRAAD / BOUCHON AVEC FILET BSP .....  | 58 |
| STOP MET METRISCHE DRAAD .....   | 59 |
| BOUCHON AVEC FILET METRIQUE .....  | 59 |
| KOPPELING 90° CONISCHE METRISCHE DRAAD .....   | 60 |
| RACCORD 9° AVEC FILET METRIQUE CONIQUE .....   | 60 |
| KOPPELING 90° MET NPT DRAAD .....  | 61 |
| RACCORD 90° AVEC FILET NPT .....   | 61 |
| KOPPELING 90° BSP CONISCHE DRAAD .....   | 62 |
| RACCORD 90° AVEC FILET BSP CONIQUE .....   | 62 |
| REGELBARE KOPPELING 90° MET BSP DRAAD .....  | 63 |
| RACCORD REGLABLE 90° AVEC FILET BSP .....  | 63 |
| REGELBARE KOPPELING 90° METRISCHE DRAAD .....  | 64 |
| RACCORD REGLABLE 90° AVEC FILET METRIQUE .....   | 64 |
| KOPPELING MET SCHOTDOORVOER 90° .....  | 65 |
| RACCORD 90° PASSSE-CLOISON .....   | 65 |
| KOPPELING 90° / UNION 90° .....  | 66 |

\* Standaard verzinkt, ook leverbaar in RVS – standard zingué, aussi livrable en inox

# SNIJRINGKOPPELINGEN / RACCORDS A BAGUE COUPANTE

## AANSLUITINGEN EN DRUK / RACCORD ET PRESSION

| Diam.<br>Buis<br>Tube | Aansluiting kant<br>snijring<br><br>Raccord côté<br>bague coupante | Inschroefdraad<br>Filetage de l'implantation |           |           | Nominale druk in<br>Bar<br><br>Pression nominale en<br>Bar |
|-----------------------|--|--|-----------|-----------|--|
|                       |  | Metrisch/Métrique                            | BSP       | NPT       |  |
| LL 4                  | M 8x1  | M 8x1 keg                                    | R 1/8 keg | NPT 1/8   | 100  |
| LL 5                  | M 10x1   | M 8x1 keg                                    | R 1/8 keg | NPT 1/8   | 100  |
| LL 6                  | M 10x1   | M 10x1 keg                                   | R 1/8 keg | NPT 1/8   | 100  |
| LL 8                  | M 12x1   | M 10x1 keg                                   | R 1/8 keg | NPT 1/8   | 100  |
| LL 10                 | M 14x1   | M 14x1,5 keg                                 | R 1/4 keg | NPT 1/4   |  |
| LL 12                 | M 16x1   | M 16x1,5 keg                                 | R 1/4 keg | NPT 1/4   |  |
| LL 16                 | M 22x1,5   |  |           |           |  |
|                       |  |  |           |           |  |
| L 6                   | M 12x1,5   | M 10x1                                       | R 1/8     | NPT 1/8   | 500  |
| L 8                   | M 14x1,5   | M 12x1,5                                     | R 1/4     | NPT 1/4   | 500  |
| L 10                  | M 16x1,5   | M 14x1,5                                     | R 1/4     | NPT 1/4   | 500  |
| L 12                  | M 18x1,5   | M 16x1,5                                     | R 3/8     | NPT 3/8   | 400  |
| L 15                  | M 22x1,5   | M 18x1,5                                     | R 1/2     | NPT 1/2   | 400  |
| L 18                  | M 26x1,5   | M 22x1,5                                     | R 1/2     | NPT 1/2   | 400  |
| L 22                  | M 30x2   | M 26x1,5                                     | R 3/4     | NPT 3/4   | 250  |
| L 28                  | M 36x2   | M 33x2                                       | R 1"      | NPT 1"    | 250  |
| L 35                  | M 45x2   | M 42x2                                       | R 1 1/4   | NPT 1 1/4 | 250  |
| L 42                  | M 52x5   | M 48x2                                       | R 1 1/2   | NPT 1 1/2 | 250  |
|                       |  |  |           |           |  |
| S 6                   | M 14x1,5   | M 12x1,5                                     | R 1/4     | NPT 1/4   | 800  |
| S 8                   | M 16x1,5   | M 14x1,5                                     | R 1/4     | NPT 1/4   | 800  |
| S 10                  | M 18x1,5   | M 16x1,5                                     | R 3/8     | NPT 3/8   | 800  |
| S 12                  | M 20x1,5   | M 18x1,5                                     | R 3/8     | NPT 3/8   | 630  |
| S 14                  | M 22x1,5   | M 20x1,5                                     | R 1/2     | NPT 1/2   | 630  |
| S 16                  | M 24x1,5   | M 22x1,5                                     | R 1/2     | NPT 1/2   | 420  |
| S 20                  | M 30x2   | M 27x2                                       | R 3/4     | NPT 3/4   | 420  |
| S 25                  | M 36x2   | M 33x2                                       | R 1"      | NPT 1"    | 420  |
| S 30                  | M 42x2   | M 42x2                                       | R 1 1/4   | NPT 1 1/4 | 420  |
| S 38                  | M 52x2   | M 48x2                                       | R 1 1/2   | NPT 1 1/2 | 420  |

LL = Zeer lichte uitvoering      L = Lichte uitvoering      S = zware uitvoering  
 LL = exécution très légère      L = exécution légère      S = exécution lourde

Standaard verzinkt, ook leverbaar in RVS – standard zingué, aussi livrable en inox

# SNIJRINGKOPPELINGEN / RACCORDS A BAGUE COUPANTE

**DRUKBEREIK / PRESSION MAX.**

## **VOLGENS DIN 3859 / SUIVANT DIN 3859**

| Serie | Buiten Ø pijp | Nominale druk in Bar     |
|-------|---------------|--------------------------|
| Série | Ø tube extér. | Pression nominale en Bar |
| LL    | 4-8           | 100                      |
| L     | 6-10          | 500                      |
| L     | 12-18         | 400                      |
| L     | 22-42         | 250                      |
| S     | 6-10          | 800                      |
| S     | 12-14         | 630                      |
| S     | 16-38         | 420                      |

Standaard verzinkt, ook leverbaar in RVS – standard zingué, aussi livrable en inox

# SNIJRINGKOPPELINGEN / RACCORDS A BAGUE COUPANTE

## LASKOPPELING / RACCORD A SOUDER

### ASV.....

| Art.N°  | Buitendiam Buis<br>Ø extérieur tube | d1 |
|---------|-------------------------------------|----|
| ASV 06L | 6                                   | 10 |
| ASV 08L | 8                                   | 12 |
| ASV 10L | 10                                  | 14 |
| ASV 12L | 12                                  | 16 |
| ASV 15L | 15                                  | 19 |
| ASV 18L | 18                                  | 22 |
| ASV 22L | 22                                  | 27 |
| ASV 28L | 28                                  | 32 |
| ASV 35L | 35                                  | 40 |
| ASV 42L | 42                                  | 46 |
|         |                                     |    |
|         |                                     |    |
|         |                                     |    |
|         |                                     |    |
|         |                                     |    |
|         |                                     |    |
|         |                                     |    |
|         |                                     |    |



|         |    |    |
|---------|----|----|
| ASV 06S | 6  | 11 |
| ASV 08S | 8  | 13 |
| ASV 10S | 10 | 15 |
| ASV 12S | 12 | 17 |
| ASV 14S | 14 | 19 |
| ASV 16S | 16 | 21 |
| ASV 20S | 20 | 26 |
| ASV 25S | 25 | 31 |
| ASV 30S | 30 | 36 |
| ASV 38S | 38 | 44 |

Standaard verzinkt, ook leverbaar in RVS – standard zingué, aussi livrable en inox

# SNIJRINGKOPPELINGEN / RACCORDS A BAGUE COUPANTE

## LASKOPPELING / RACCORD A SOUDER

### LAS-KV.....

| Art.N°        | Buis<br>Tube | D1   | L1   |
|---------------|--------------|------|------|
| LAS-KV 6x1.75 | 6            | 2.5  | 31.0 |
| LAS-KV 8x2    | 8            | 4.0  | 31.0 |
| LAS-KV 10x1.5 | 10           | 7.0  | 32.5 |
| LAS-KV 10x2   | 10           | 6.0  | 32.5 |
| LAS-KV 12x1.5 | 12           | 9.0  | 32.5 |
| LAS-KV 12x2   | 12           | 8.0  | 32.5 |
| LAS-KV 12x2.5 | 12           | 7.0  | 32.5 |
| LAS-KV 14x3   | 14           | 8.0  | 38.5 |
| LAS-KV 15x2.5 | 15           | 10.0 | 34.0 |
| LAS-KV 16x2   | 16           | 12.0 | 39.0 |
| LAS-KV 16x2.5 | 16           | 11.0 | 39.0 |
| LAS-KV 16x3   | 16           | 10.0 | 39.0 |
| LAS-KV 18x2.5 | 18           | 13.0 | 35.5 |
| LAS-KV 20x2.5 | 20           | 15.0 | 45.0 |
| LAS-KV 20x3   | 20           | 14.0 | 45.0 |
| LAS-KV 20x4   | 20           | 12.0 | 45.0 |
| LAS-KV 22x2.5 | 22           | 17.0 | 38.5 |
| LAS-KV 25x3   | 25           | 19.0 | 49.5 |
| LAS-KV 25x4   | 25           | 17.0 | 49.5 |
| LAS-KV 25x5   | 25           | 15.0 | 49.5 |

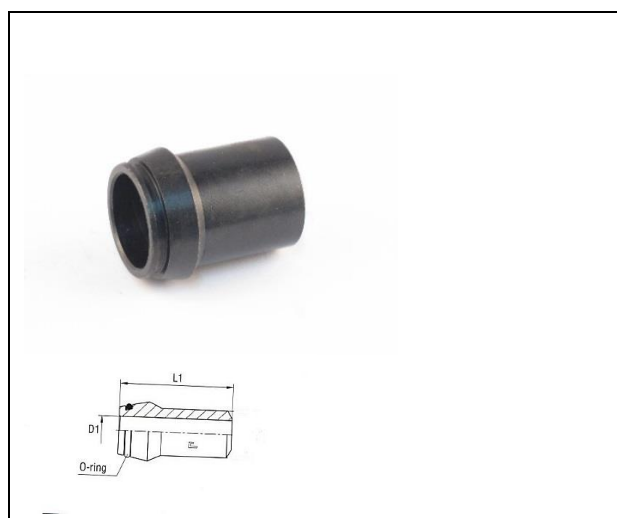

|               |    |      |      |
|---------------|----|------|------|
| LAS-KV 28x2.5 | 28 | 23.0 | 41.5 |
| LAS-KV 30x3   | 30 | 24.0 | 52.0 |
| LAS-KV 30x4   | 30 | 22.0 | 52.0 |
| LAS-KV 30x5   | 30 | 20.0 | 52.0 |
| LAS-KV 30x6   | 30 | 18.0 | 52.0 |
| LAS-KV 35x3   | 35 | 29.0 | 47.5 |
| LAS-KV 38x3   | 38 | 32.0 | 56.5 |
| LAS-KV 38x5   | 38 | 28.0 | 56.5 |
| LAS-KV 38x6   | 38 | 26.0 | 56.5 |
| LAS-KV 38x7   | 38 | 22.2 | 56.5 |
| LAS-KV 42x3   | 42 | 36.0 | 47.5 |

Standaard verzinkt, ook leverbaar in RVS – standard zingué, aussi livrable en inox

# SNIJRINGKOPPELINGEN / RACCORDS A BAGUE COUPANTE

## RICHTBARE KOPPELING MET METR. BUITENDRAAD RACCORD ORIENTABLE AVEC FILET EXTER. METRIQUE

### EGES.....M SV

| Art.N°               | d1 | M        |
|----------------------|----|----------|
| EGES 06L M10x1 SV    | 6  | M 10x1   |
| EGES 06L M12x1,5 SV  | 6  | M 10x1,5 |
| EGES 08L M12x1,5 SV  | 8  | M 12x1,5 |
| EGES 08L M14x1,5 SV  | 8  | M 14x1,5 |
| EGES 10L M14x1,5 SV  | 10 | M 14x1,5 |
| EGES 10L M16x1,5 SV  | 10 | M 16x1,5 |
| EGES 12L M 14x1,5 SV | 12 | M 14x1,5 |
| EGES 12L M16x1,5 SV  | 12 | M 16x1,5 |
| EGES 12L M22x1,5 SV  | 12 | M 22X1,5 |
| EGES 15L M18x1,5 SV  | 15 | M 18x1,5 |
| EGES 15L M 22x1,5 SV | 15 | M 22x1,5 |
| EGES 18L M22x1,5 SV  | 18 | M 22x1,5 |
| EGES 18L M26x1,5 SV  | 18 | M 26x1,5 |
| EGES 22L M26x1,5 SV  | 22 | M 26x1,5 |
| EGES 28L M33x2 SV    | 28 | M 33x2   |
| EGES 35L M42x2 SV    | 35 | M 42x2   |
| EGES 42L M48x2 SV    | 42 | M 48x2   |
|                      |    |          |
|                      |    |          |
|                      |    |          |
|                      |    |          |
|                      |    |          |
|                      |    |          |
|                      |    |          |
|                      |    |          |
|                      |    |          |
|                      |    |          |



|                      |    |          |
|----------------------|----|----------|
| EGES 06S M10x1 SV    | 6  | M 10x1   |
| EGES 06S M12x1,5 SV  | 6  | M 12x1,5 |
| EGES 08S M12x1,5 SV  | 8  | M 12x1,5 |
| EGES 08S M14x1,5 SV  | 8  | M 14x1,5 |
| EGES 10S M14x1,5 SV  | 10 | M 14x1,5 |
| EGES 10S M16x1,5 SV  | 10 | M 16x1,5 |
| EGES 12S M 14x1,5 SV | 12 | M 14x1,5 |
| EGES 12S M 16x1,5 SV | 12 | M 16x1,5 |
| EGES 12S M 18x1,5 SV | 12 | M 18x1,5 |
| EGES 12S M 22x1,5 SV | 12 | M 22x1,5 |
| EGES 14S M 20x1,5 SV | 14 | M 20x1,5 |
| EGES 14S M 22x1,5SV  | 14 | M 22x1,5 |
| EGES 16S M 22x1,5 SV | 16 | M 22x1,5 |
| EGES 20S M 27x2 SV   | 20 | M 27x2   |
| EGES 25S M 33x2 SV   | 25 | M 33x2   |
| EGES 30S M 42x2 SV   | 30 | M 42x2   |
| EGES 38S M 48x2 SV   | 38 | M 48x2   |
|                      |    |          |
|                      |    |          |

\* Standaard verzinkt, ook leverbaar in RVS – standard zingué, aussi livrable en inox

# SNIJRINGKOPPELINGEN / RACCORDS A BAGUE COUPANTE

## RICHTBARE KOPPELINGEN MET NPT BUITENDRAAD RACCORD ORIENTABLE AVEC FILET EXTERIEUR NPT

### EGES.....NPT SV

| Art.N°             | d1 | NPT     |
|--------------------|----|---------|
| EGES 06L 1/8NPT SV | 6  | 1/8 NPT |
| EGES 08L 1/4NPT SV | 8  | 1/4 NPT |
| EGES 10L 1/4NPT SV | 10 | 1/4 NPT |
| EGES 12L 3/8NPT SV | 12 | 3/8 NPT |
| EGES 15L 1/2NPT SV | 15 | 1/2 NPT |
| EGES 18L 1/2NPT SV | 18 | 1/2 NPT |
| EGES 22L 3/4NPT SV | 22 | 3/4 NPT |
| EGES 28L 1NPT SV   | 28 | 1" NPT  |
| EGES 35L 1 ¼NPT SV | 35 | 1 ¼ NPT |
| EGES 42L 1 ½NPT SV | 42 | 1 ½ NPT |
|                    |    |         |
|                    |    |         |
|                    |    |         |
|                    |    |         |
|                    |    |         |
|                    |    |         |
|                    |    |         |

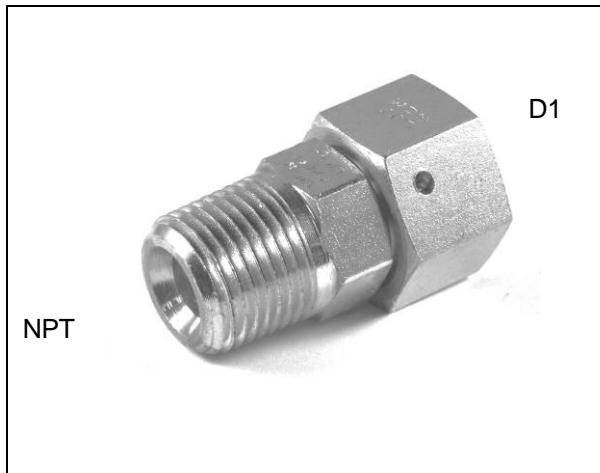

|                    |    |         |
|--------------------|----|---------|
| EGES 06S 1/4NPT SV | 6  | 1/4 NPT |
| EGES 08S 1/4NPT SV | 8  | 1/4 NPT |
| EGES 10S 3/8NPT SV | 10 | 3/8 NPT |
| EGES 12S 3/8NPT SV | 12 | 3/8 NPT |
| EGES 14S 1/2NPT SV | 14 | 1/2 NPT |
| EGES 16S 1/2NPT SV | 16 | 1/2 NPT |
| EGES 20S 3/4NPT SV | 20 | 3/4 NPT |
| EGES 25S 1NPT SV   | 25 | 1" NPT  |
| EGES 30S 1 ¼NPT SV | 30 | 1 ¼ NPT |
| EGES 38S 1 ½NPT SV | 38 | 1 ½ NPT |

Standaard verzinkt, ook leverbaar in RVS – standard zingué, aussi livrable en inox



# SNIJRINGKOPPELINGEN / RACCORDS A BAGUE COUPANTE

## **RICHTBARE KOPPELING MET BSP BUITENDRAAD** **RACCORD ORIENTABLE AVEC FILET EXTERIEUR BSP**

### **EGES.....R SV**

| Art.N°              | d1 | G       |
|---------------------|----|---------|
| EGES 06L R1/8 SV    | 6  | G 1/8   |
| EGES 06L R1/4 SV    | 6  | G 1/4   |
| EGES 08L R1/4 SV    | 8  | G 1/4   |
| EGES 10L R1/4 SV    | 10 | G 1/4   |
| EGES 10L R3/8 SV    | 10 | G 3/8   |
| EGES 12L R1/4 SV    | 12 | G 1/4   |
| EGES 12L R3/8 SV    | 12 | G 3/8   |
| EGES 12 L R1/2 SV   | 12 | G 1/2   |
| EGES 13L R1/4 SV    | 13 | G 1/4   |
| EGES 13L R3/8 SV    | 13 | G 3/8   |
| EGES 13L R1/2 SV    | 13 | G 1/2   |
| EGES 15L R3/8 SV    | 15 | G 3/8   |
| EGES 15L R1/2 SV    | 15 | G 1/2   |
| EGES 15L R3/4 SV    | 15 | G 3/4   |
| EGES 17L R3/8 SV    | 17 | G 3/8   |
| EGES 17L R1/2 SV    | 17 | G 1/2   |
| EGES 18L R1/2 SV    | 18 | G 1/2   |
| EGES 18L R3/4 SV    | 18 | G 3/4   |
| EGES 21L R1/2 SV    | 21 | G 1/2   |
| EGES 21L R3/4 SV    | 21 | G 3/4   |
| EGES 22L R3/4 SV    | 22 | G 3/4   |
| EGES 22L R1 SV      | 22 | G 1"    |
| EGES 27L R3/4 SV    | 27 | G 3/4   |
| EGES 27 L R1" SV    | 27 | G 1"    |
| EGES 28L R3/4 SV    | 28 | G 3/4   |
| EGES 28L R1 SV      | 28 | G 1"    |
| EGES 33 L R1 SV     | 33 | G 1"    |
| EGES 33 L R1 1/4 SV | 33 | G 1 1/4 |
| EGES 35L R1 SV      | 35 | G 1"    |
| EGES 35L R1 1/4 SV  | 35 | G 1 1/4 |
| EGES 35L R1 1/2 SV  | 35 | G 1 1/2 |
| EGES 42L R1 1/2 SV  | 42 | G 1 1/2 |



|                     |    |         |
|---------------------|----|---------|
| EGES 06S R1/8 SV    | 6  | G 1/8   |
| EGES 06S R1/4 SV    | 6  | G 1/4   |
| EGES 08S R1/4 SV    | 8  | G 1/4   |
| EGES 08S R3/8 SV    | 8  | G 3/8   |
| EGES 10S R1/4 SV    | 10 | G 1/4   |
| EGES 10S R3/8 SV    | 10 | G 3/8   |
| EGES 10S R1/2 SV    | 10 | G 1/2   |
| EGES 12S R1/4 SV    | 12 | G 1/4   |
| EGES 12S R3/8 SV    | 12 | G 3/8   |
| EGES 12S R1/2 SV    | 12 | G 1/2   |
| EGES 14S R3/8 SV    | 14 | G 3/8   |
| EGES 14S R1/2 SV    | 14 | G 1/2   |
| EGES 16S R3/8 SV    | 16 | G 3/8   |
| EGES 16S R1/2 SV    | 16 | G 1/2   |
| EGES 16S R3/4 SV    | 16 | G 3/4   |
| EGES 20S R1/2 SV    | 20 | G 1/2   |
| EGES 20S R3/4 SV    | 20 | G 3/4   |
| EGES 20S R1 SV      | 25 | G 1"    |
| EGES 25S R1/2 SV    | 25 | G 1/2   |
| EGES 25S R3/4 SV    | 25 | G 3/4   |
| EGES 25S R1 SV      | 25 | G 1"    |
| EGES 25S R 1 1/4 SV | 25 | G 1 1/4 |
| EGES 30S R1 SV      | 30 | G 1"    |

Standaard verzinkt, ook leverbaar in RVS – standard zingué, aussi livrable en inox

## SNIJRINGKOPPELINGEN / RACCORDS A BAGUE COUPANTE

**RICHTBARE KOPPELING MET BSP BUITENDRAAD  
RACCORD ORIENTABLE AVEC FILET EXTERIEUR BSP**

## EGES.....R SV (vervolg – suite)

[illegible]

\* Standaard verzinkt, ook leverbaar in RVS – standard zingué, aussi livrable en inox

# SNIJRINGKOPPELINGEN / RACCORDS A BAGUE COUPANTE

## RICHTBARE "T" KOPPELING / RACCORD "T" ORIENTABLE

### ELV.....SV

| Art.N°     | Buitendiam. buis<br>Ø extérieur tube |
|------------|--------------------------------------|
| ELV 06L SV | 6                                    |
| ELV 08L SV | 8                                    |
| ELV 10L SV | 10                                   |
| ELV 12L SV | 12                                   |
| ELV 15L SV | 15                                   |
| ELV 18L SV | 18                                   |
| ELV 22L SV | 22                                   |
| ELV 28L SV | 28                                   |
| ELV 35L SV | 35                                   |
| ELV 42L SV | 42                                   |
|            |                                      |
|            |                                      |
|            |                                      |
|            |                                      |
|            |                                      |
|            |                                      |
|            |                                      |
|            |                                      |

Met o-ring  
Avec o-ring



|            |    |
|------------|----|
| ELV 06S SV | 6  |
| ELV 08S SV | 8  |
| ELV 10S SV | 10 |
| ELV 12S SV | 12 |
| ELV 14S SV | 14 |
| ELV 16S SV | 16 |
| ELV 20S SV | 20 |
| ELV 25S SV | 25 |
| ELV 30S SV | 30 |
| ELV 38S SV | 38 |

Standaard verzinkt, ook leverbaar in RVS – standard zingué, aussi livrable en inox

# SNIJRINGKOPPELINGEN / RACCORDS A BAGUE COUPANTE

## RICHTBARE "T" KOPPELING / RACCORD "T" ORIENTABLE

### ETV.....SV

| Art.N°     | Buitendiam. buis<br>Ø extérieur tube |
|------------|--------------------------------------|
| ETV 06L SV | 6                                    |
| ETV 08L SV | 8                                    |
| ETV 10L SV | 10                                   |
| ETV 12L SV | 12                                   |
| ETV 15L SV | 15                                   |
| ETV 18L SV | 18                                   |
| ETV 22L SV | 22                                   |
| ETV 28L SV | 28                                   |
| ETV 35L SV | 35                                   |
| ETV 42L SV | 42                                   |
|            |                                      |
|            |                                      |
|            |                                      |
|            |                                      |
|            |                                      |
|            |                                      |
|            |                                      |
|            |                                      |

Met o-ring  
Avec o-ring

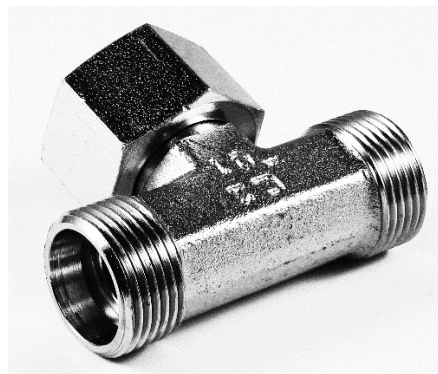

|            |    |
|------------|----|
| ETV 06S SV | 6  |
| ETV 08S SV | 8  |
| ETV 10S SV | 10 |
| ETV 12S SV | 12 |
| ETV 14S SV | 14 |
| ETV 16S SV | 16 |
| ETV 20S SV | 20 |
| ETV 25S SV | 25 |
| ETV 30S SV | 30 |
| ETV 38S SV | 38 |

\* Standaard verzinkt, ook leverbaar in RVS – standard zingué, aussi livrable en inox

# SNIJRINGKOPPELINGEN / RACCORDS A BAGUE COUPANTE

## KOPPELING VOOR MANOMETERS MET VLAKKE ZITTING RACCORD POUR MANOMETRE AVEC SIEGE PLAT

### EMAS.....R SV

| Art.N°           | G     | buiten Ø<br>Ø extér. |
|------------------|-------|----------------------|
| EMAS 06L R1/4 SV | G 1/4 | 6                    |
| EMAS 08L R1/4 SV | G 1/4 | 8                    |
| EMAS 10L R1/4 SV | G 1/4 | 10                   |
| EMAS 12L R1/4 SV | G 1/4 | 12                   |
| EMAS 06S R1/2 SV | G 1/2 | 6                    |
| EMAS 08S R1/2 SV | G 1/2 | 8                    |
| EMAS 10S R1/2 SV | G 1/2 | 10                   |
| EMAS 12S R1/2 SV | G 1/2 | 12                   |

Met o-ring  
Avec o-ring

G

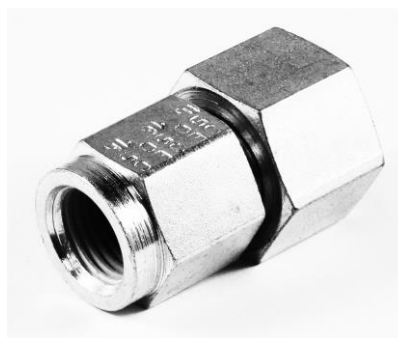

Standaard verzinkt, ook leverbaar in RVS – standard zingué, aussi livrable en inox

# SNIJRINGKOPPELINGEN / RACCORDS A BAGUE COUPANTE

## BSP REDUCTIES / REDUCTIONS BSP

### RED.....R...

| Art.N°          | G1    | G2      |
|-----------------|-------|---------|
| RED R1/8R1/4    | G 1/8 | G 1/4   |
| RED R1/8 R3/8   | G 1/8 | G 3/8   |
| RED R1/4 R1/8   | G 1/4 | G 1/8   |
| RED R1/4 R3/8   | G 1/4 | G 3/8   |
| RED R1/4 R1/2   | G 1/4 | G 1/2   |
| RED R1/4 R3/4   | G 1/4 | G 3/4   |
| RED R3/8 R1/8   | G 3/8 | G 1/8   |
| RED R3/8 R1/4   | G 3/8 | G 1/4   |
| RED R3/8 R1/2   | G 3/8 | G 1/2   |
| RED R3/8 R3/4   | G 3/8 | G 3/4   |
| RED R1/2 R1/8   | G 1/2 | G 1/8   |
| RED R1/2 R1/4   | G 1/2 | G 1/4   |
| RED R1/2 R3/8   | G 1/2 | G 3/8   |
| RED R1/2 R3/4   | G 1/2 | G 3/4   |
| RED R1/2 R1     | G 1/2 | G 1"    |
| RED R1/2 R1 1/4 | G 1/2 | G 1 1/4 |
| RED R3/4 R1/4   | G 3/4 | G 1/4   |
| RED R3/4 R3/8   | G 3/4 | G 3/8   |
| RED R3/4 R1/2   | G 3/4 | G 1/2   |
| RED R3/4 R1     | G 3/4 | G 1"    |
| RED R3/4 R1 1/4 | G 3/4 | G 1 1/4 |
| RED R3/4 R1 1/2 | G 3/4 | G 1 1/2 |
| RED R1 R1/4     | G 1"  | G 1/4   |
| RED R1 R3/8     | G 1"  | G 3/8   |
|                 |       |         |
|                 |       |         |



|                   |         |         |
|-------------------|---------|---------|
| RED R1 R1/2       | G 1"    | G 1/2   |
| RED R1 R3/4       | G 1"    | G 3/4   |
| RED R1 R1 1/4     | G 1"    | G 1 1/4 |
| RED R1 R1 1/2     | G 1"    | G 1 1/2 |
| RED R1 1/4 R1/2   | G 1 1/4 | G 1/2   |
| RED R1 1/4 R3/4   | G 1 1/4 | G 3/4   |
| RED R1 1/4 R1     | G 1 1/4 | G 1"    |
| RED R1 1/4 R1 1/2 | G 1 1/4 | G 1 1/2 |
| RED R1 1/2 R1/2   | G 1 1/2 | G 1/2   |
| RED R1 1/2 R3/4   | G 1 1/2 | G 3/4   |
| RED R1 1/2 R1     | G 1 1/2 | G 1"    |
| RED R1 1/2 R1 1/4 | G 1 1/2 | G 1 1/4 |

Standaard verzinkt, ook leverbaar in RVS – standard zingué, aussi livrable en inox

# SNIJRINGKOPPELINGEN / RACCORDS A BAGUE COUPANTE

## RICHTBARE KOPPELING 90° / RACCORD ORIENTABLE 90°

### EWV.....SV

| Art.N°           | Buitendiam.buis | d  |
|------------------|-----------------|----|
| Ø extérieur tube |                 |    |
| EWV 06L SV       | 6               | 6  |
| EWV 08L SV       | 8               | 8  |
| EWV 10L SV       | 10              | 10 |
| EWV 12L SV       | 12              | 12 |
| EWV 13L SV       | 13              | 13 |
| EWV 15L SV       | 15              | 15 |
| EWV 17L SV       | 17              | 17 |
| EWV 18L SV       | 18              | 18 |
| EWV 21L SV       | 21              | 21 |
| EWV 22L SV       | 22              | 22 |
| EWV 27L SV       | 27              | 27 |
| EWV 28L SV       | 28              | 28 |
| EWV 33L SV       | 33              | 33 |
| EWV 35L SV       | 35              | 35 |
| EWV 42L SV       | 42              | 42 |
|                  |                 |    |
|                  |                 |    |
|                  |                 |    |

Met o-ring  
Avec o-ring

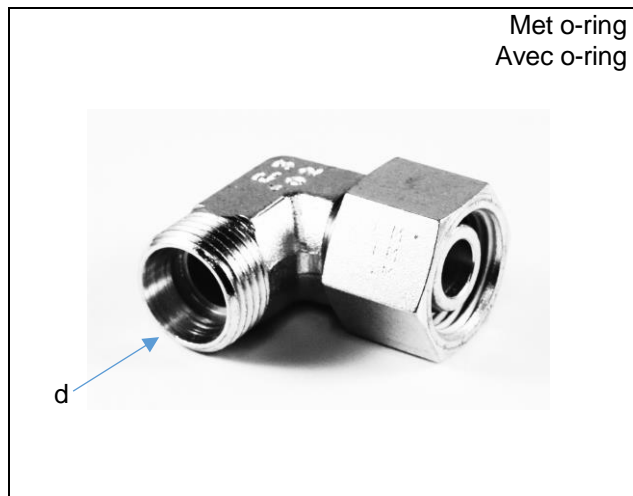

|            |    |    |
|------------|----|----|
| EWV 06S SV | 6  | 6  |
| EWV 08S SV | 8  | 8  |
| EWV 10S SV | 10 | 10 |
| EWV 12S SV | 12 | 12 |
| EWV 14S SV | 14 | 14 |
| EWV 16S SV | 16 | 16 |
| EWV 20S SV | 20 | 20 |
| EWV 25S SV | 25 | 25 |
| EWV 30S SV | 30 | 30 |
| EWV 38S SV | 38 | 38 |

Standaard verzinkt, ook leverbaar in RVS – standard zingué, aussi livrable en inox

# SNIJRINGKOPPELINGEN / RACCORDS A BAGUE COUPANTE

## RICHTBARE KOPPELING 45° / RACCORD ORIENTABLE 45°

### EWV45.....SV

| Art.N°       | Buitendiam.buis<br>Ø extérieur tube | d  |
|--------------|-------------------------------------|----|
| EWV45-06L SV | 6                                   | 6  |
| EWV45-08L SV | 8                                   | 8  |
| EWV45-10L SV | 10                                  | 10 |
| EWV45-12L SV | 12                                  | 12 |
| EWV45-15L SV | 15                                  | 15 |
| EWV45-18L SV | 18                                  | 18 |
| EWV45-22L SV | 22                                  | 22 |
| EWV45-28L SV | 28                                  | 28 |
| EWV45-35L SV | 35                                  | 35 |
| EWV45-42L SV | 42                                  | 42 |
|              |                                     |    |
|              |                                     |    |
|              |                                     |    |
|              |                                     |    |
|              |                                     |    |
|              |                                     |    |
|              |                                     |    |
|              |                                     |    |

Met o-ring  
Avec o-ring

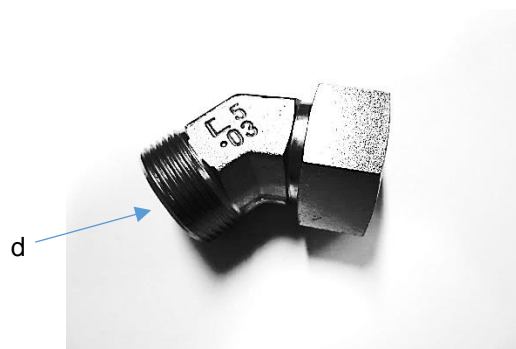

|              |    |    |
|--------------|----|----|
| EWV45-06S SV | 6  | 6  |
| EWV45-08S SV | 8  | 8  |
| EWV45-10S SV | 10 | 10 |
| EWV45-12S SV | 12 | 12 |
| EWV45-14S SV | 14 | 14 |
| EWV45-16S SV | 16 | 16 |
| EWV45-20S SV | 20 | 20 |
| EWV45-25S SV | 25 | 25 |
| EWV45-30S SV | 30 | 30 |
| EWV45-38S SV | 38 | 38 |

\* Standaard verzinkt, ook leverbaar in RVS – standard zingué, aussi livrable en inox



# SNIJRINGKOPPELINGEN / RACCORDS A BAGUE COUPANTE

## KOPPELING MET METRISCHE BINNENDRAAD RACCORD AVEC FILET METRIQUE INTERIEUR

### GAV.....M

| Art.N°          | M          | Ø buis<br>Ø tube |
|-----------------|------------|------------------|
| GAV 06L M10x1   | M 10 x 1   | 6                |
| GAV 08L M12x1,5 | M 12 x 1,5 | 8                |
| GAV 10L M14x1,5 | M 14 x 1,5 | 10               |
| GAV 12L M16x1,5 | M 16 x 1,5 | 12               |
| GAV 15L M18x1,5 | M 18 x 1,5 | 15               |
| GAV 18L M22x1,5 | M 22 x 1,5 | 18               |
| GAV 22L M26x1,5 | M 26 x 1,5 | 22               |
| GAV 28L M33x2   | M 33 x 2   | 28               |
| GAV 35L M42x2   | M 42 x 2   | 35               |
| GAV 42L M48x2   | M 48 x 2   | 42               |
|                 |            |                  |
|                 |            |                  |
|                 |            |                  |
|                 |            |                  |
|                 |            |                  |
|                 |            |                  |

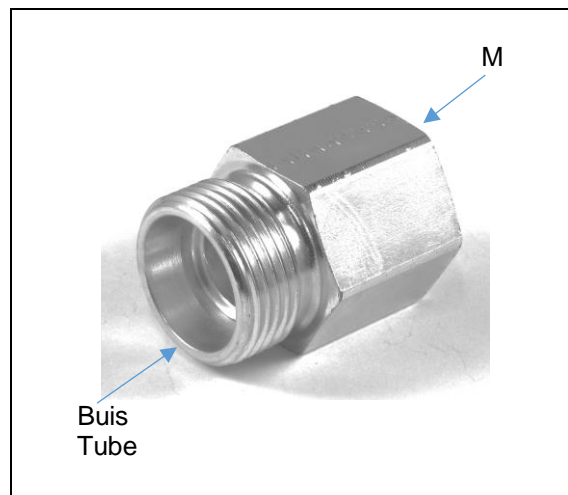

|                 |            |    |
|-----------------|------------|----|
| GAV 06S M12x1,5 | M 12 x 1,5 | 6  |
| GAV 08S M14x1,5 | M 14 x 1,5 | 8  |
| GAV 10S M16x1,5 | M 16 x 1,5 | 10 |
| GAV 12S M18x1,5 | M 18 x 1,5 | 12 |
| GAV 16S M22x1,5 | M 22x 1,5  | 16 |
| GAV 20S M27x2   | M 27 x 2   | 20 |
| GAV 25S M33x2   | M 33 x 2   | 25 |
| GAV 30S M42x2   | M 42 x 2   | 30 |
| GAV 38S M48x2   | M 48 x 2   | 38 |

Standaard verzinkt, ook leverbaar in RVS – standard zingué, aussi livrable en inox

## SNIJRINGKOPPELINGEN / RACCORDS A BAGUE COUPANTE

### KOPPELING MET BSP BINNENDRAAD RACCORD AVEC FILET INTERIEUR BSP

#### GAV.....R

| Art.N°         | Ø buis<br>Ø tube | G       |
|----------------|------------------|---------|
| GAV 06L R1/8   | 6                | G 1/8   |
| GAV 08L R1/4   | 8                | G 1/4   |
| GAV 08L R1/2   | 8                | G 1/2   |
| GAV 08L R3/8   | 8                | G 3/8   |
| GAV 10L R1/4   | 10               | G 1/4   |
| GAV 10L R3/8   | 10               | G 3/8   |
| GAV 10L R1/2   | 10               | G 1/2   |
| GAV 12L R1/4   | 12               | G 1/4   |
| GAV 12L R3/8   | 12               | G 3/8   |
| GAV 12L R1/2   | 12               | G 1/2   |
| GAV 15L R3/8   | 15               | G 3/8   |
| GAV 15L R1/2   | 15               | G 1/2   |
| GAV 18L R1/2   | 18               | G 1/2   |
| GAV 22L R3/4   | 22               | G 3/4   |
| GAV 28L R1     | 28               | G 1"    |
| GAV 35L R1 1/4 | 35               | G 1 1/4 |
| GAV 42L R1 1/2 | 42               | G 1 1/2 |

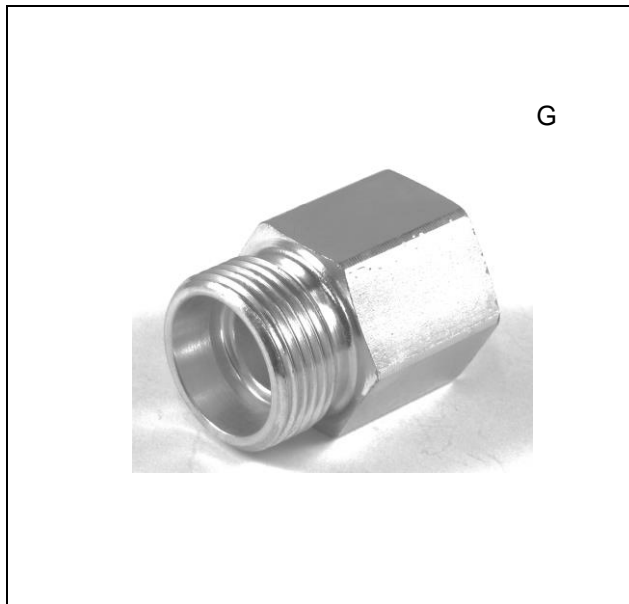

|                |    |         |
|----------------|----|---------|
| GAV 06S R1/4   | 6  | G 1/4   |
| GAV 08S R1/4   | 8  | G 1/4   |
| GAV 10S R3/8   | 10 | G 3/8   |
| GAV 12S R3/8   | 12 | G 3/8   |
| GAV 14S R1/2   | 14 | G 1/2   |
| GAV 16S R1/2   | 16 | G 1/2   |
| GAV 20S R3/4   | 20 | G 3/4   |
| GAV 25S R1     | 25 | G 1"    |
| GAV 30S R1 1/4 | 30 | G 1 1/4 |
| GAV 38S R1 1/2 | 38 | G 1 1/2 |

\* Standaard verzinkt, ook leverbaar in RVS – standard zingué, aussi livrable en inox

# SNIJRINGKOPPELINGEN / RACCORDS A BAGUE COUPANTE

## KOPPELINGEN MET FLENZEN - 3000PSI RACCORDS A BRIDES – 3000PSI

### GEV..L/S-3-..SFH

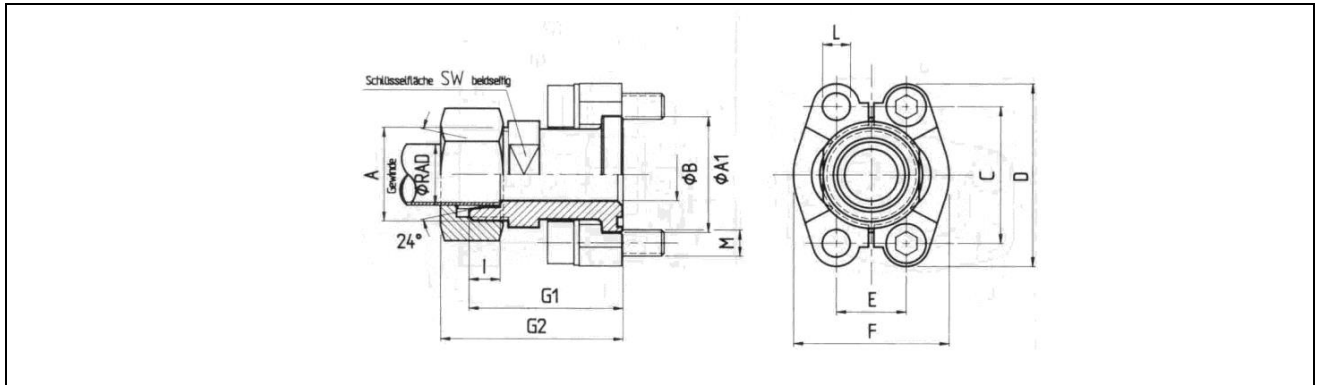

\* zie rubriek M - "Flenskoppelingen"

OOK LEVERBAAR MET VOLLE FLENS

REFERENTIE = FGEV.....

Ook verkrijgbaar in 90° ( WEV...-3-..SFH )

\* Voir rubrique M – "Brides"

LIVRABLES AVEC BRIDES MONOBLOC AVEC TROUS TARAUDÉS

REFERENCE = FGEV.....

LIVRABLES EN 90° ( WEV...-3-..SFH )

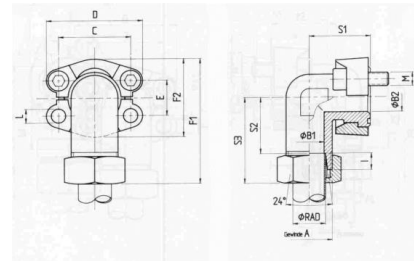

Standaard verzinkt, ook leverbaar in RVS – standard zingué, aussi livrable en inox

© 2018 Van de Calseyde BVBA - wettelijk beschermd / reproduction interdite

13-12-2018

# SNIJRINGKOPPELINGEN / RACCORDS A BAGUE COUPANTE

## KOPPELINGEN MET FLENZEN – 6000PSI RACCORDS A BRIDES – 6000PSI

GEV..L/S-6-..SFH

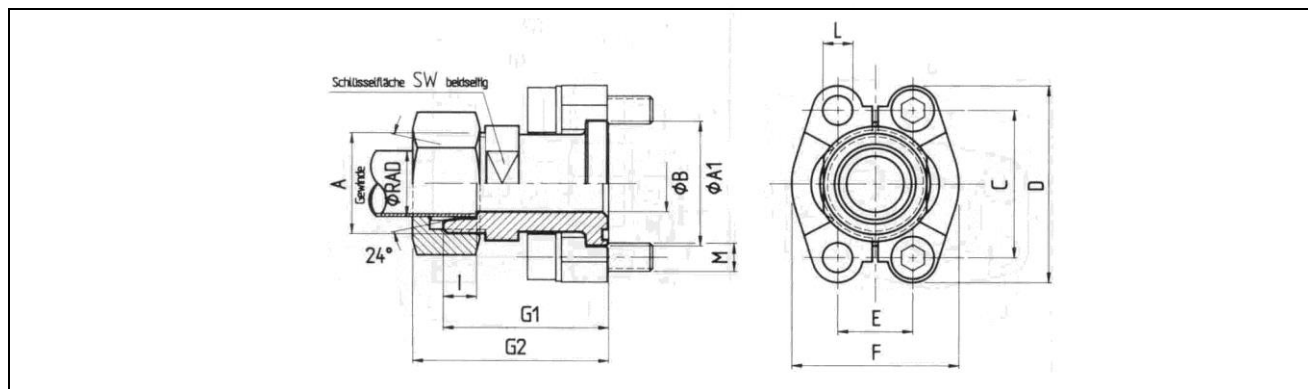

\* zie rubriek M – “Flenskoppelingen”  
OOK VERKRIJGBAAR IN 90° ( WEV...-6-..SFH )  
OOK LEVERBAAR MET FLENS (FGEV)

Voir rubrique M – "Brides"  
LIVRABLES EN 90° ( WEV...-6-..SFH )  
LIVRABLES AVEC BRIDE (FGEV)

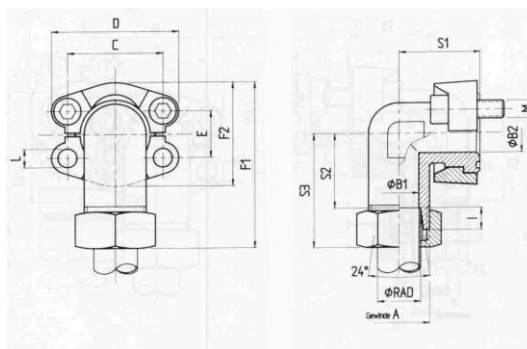

\* Standaard verzinkt, ook leverbaar in RVS – standard zingué, aussi livrable en inox

# SNIJRINGKOPPELINGEN / RACCORDS A BAGUE COUPANTE

## KOPPELING MET METRISCHE BUITENDRAAD RACCORD AVEC FILET METRIQUE EXTERIEUR

### GEV.....M

| Art.N°          | Buitendiam.<br>buis<br>Ø extérieur<br>tube | M        |
|-----------------|--|----------|
| GEV 06LL M10x1  | 6  | M 10x1   |
| GEV 08LL M10x1  | 8  | M 10x1   |
| GEV 06L M10x1   | 6  | M 10x1   |
| GEV 06L M12x1,5 | 6  | M 12x1,5 |
| GEV 06L M14x1,5 | 6  | M 14x1,5 |
| GEV 06L M16x1,5 | 6  | M 16x1,5 |
| GEV 06L M18x1,5 | 6  | M 18x1,5 |
| GEV 06L M22x1,5 | 6  | M 22x1,5 |
| GEV 08L M10x1   | 8  | M 10x1   |
| GEV 08L M12x1,5 | 8  | M 12x1,5 |
| GEV 08L M14x1,5 | 8  | M 14x1,5 |
| GEV 08L M16x1,5 | 8  | M 16x1,5 |
| GEV 08L M18x1,5 | 8  | M 18x1,5 |
| GEV 08L M22x1,5 | 8  | M 22x1,5 |
| GEV 10L M12x1,5 | 10   | M 12x1,5 |
| GEV 10L M14x1,5 | 10   | M 14x1,5 |
| GEV 10L M16x1,5 | 10   | M 16x1,5 |
| GEV 10L M18x1,5 | 10   | M 18x1,5 |
| GEV 10L M22x1,5 | 10   | M 22x1,5 |
| GEV 12L M12x1,5 | 12   | M 12x1,5 |
| GEV 12L M14x1,5 | 12   | M 14x1,5 |
| GEV 12L M16x1,5 | 12   | M 16x1,5 |
| GEV 12L M18x1,5 | 12   | M 18x1,5 |
| GEV 12L M22x1,5 | 12   | M 22x1,5 |
| GEV 13L M16x1,5 | 13   | M 16x1,5 |
| GEV 13L M18x1,5 | 13   | M 18x1,5 |
| GEV 15L M16x1,5 | 15   | M 16x1,5 |
| GEV 15L M18x1,5 | 15   | M 18x1,5 |
| GEV 15L M22x1,5 | 15   | M 22x1,5 |
| GEV 15L M26x1,5 | 15   | M 26x1,5 |
| GEV 17L M18x1,5 | 17   | M 18x1,5 |
| GEV 17L M20x1,5 | 17   | M 20x1,5 |
| GEV 17L M22x1,5 | 17   | M 22x1,5 |
| GEV 18L M18X1,5 | 18   | M 18X1,5 |



|                 |    |          |
|-----------------|----|----------|
| GEV 18L M22x1,5 | 18 | M 22x1,5 |
| GEV 18L M26x1,5 | 18 | M 26x1,5 |
| GEV 18L M27x2   | 18 | M27x2    |
| GEV 21L M22x1,5 | 21 | M 22x1,5 |
| GEV 22L M18x1,5 | 22 | M 18x1,5 |
| GEV 22L M22x1,5 | 22 | M 22x1,5 |
| GEV 22L M26x1,5 | 22 | M 26x1,5 |
| GEV 28L M33x2   | 28 | M 33x2   |
| GEV 35L M42x2   | 35 | M 42x2   |
| GEV 42L M48x2   | 42 | M 48x2   |
| GEV 06S M12x1,5 | 6  | M 12x1,5 |
| GEV 08S M14x1,5 | 8  | M 14x1,5 |
| GEV 10S M16x1,5 | 10 | M 16x1,5 |
| GEV 10S M18x1,5 | 10 | M 18x1,5 |
| GEV 12S M14x1,5 | 12 | M 14x1,5 |
| GEV 12S M16x1,5 | 12 | M 16x1,5 |
| GEV 12S M18x1,5 | 12 | M 18x1,5 |
| GEV 12S M22x1,5 | 12 | M22x1,5  |
| GEV 14S M18x1,5 | 14 | M 18x1,5 |
| GEV 14S M20x1,5 | 14 | M 20x1,5 |
| GEV 16S M16x1,5 | 16 | M 16x1,5 |
| GEV 16S M18x1,5 | 16 | M 18x1,5 |
| GEV 16S M22x1,5 | 16 | M 22x1,5 |
| GEV 20S M22x1,5 | 20 | M 22x1,5 |
| GEV 20S M27x2   | 20 | M 27x2   |
| GEV 25S M33x2   | 25 | M 33x2   |
| GEV 30S M42x2   | 30 | M 42x2   |
| GEV 38S M48x2   | 38 | M 48x2   |

Standaard verzinkt, ook leverbaar in RVS – standard zingué, aussi livrable en inox

# SNIJRINGKOPPELINGEN / RACCORDS A BAGUE COUPANTE

## KOPPELING MET CONISCHE METR. BUITENDRAAD RACCORD AVEC FILET METRIQUE CONIQUE EXT.

### GEV.....MK

| Art.N°           | Buitendiam<br>. buis<br>Ø<br>extérieur<br>tube | Metr.con. |
|------------------|--|-----------|
| GEV 04LL MK6x1   | 4  | M 6x1     |
| GEV 04LL MK8x1   | 4  | M 8x1     |
| GEV 04LL MK10x1  | 4  | M 10x1    |
| GEV 05LL MK8x1   | 5  | M 8x1     |
| GEV 06LL MK6x1   | 6  | M 6x1     |
| GEV 06LL MK8x1   | 6  | M 8x1     |
| GEV 06LL MK10x1  | 6  | M 10x1    |
| GEV 08LL MK10x1  | 8  | M 10x1    |
| GEV 06L MK10x1   | 6  | M 10x1    |
| GEV 08L MK12x1,5 | 8  | M 12x1,5  |
| GEV 10L MK14x1,5 | 10   | M 14x1,5  |
| GEV 12L MK16x1,5 | 12   | M 16x1,5  |
| GEV 15L MK18x1,5 | 15   | M 18x1,5  |
| GEV 18L MK22x1,5 | 18   | M 22x1,5  |
|                  |  |           |
|                  |  |           |
|                  |  |           |

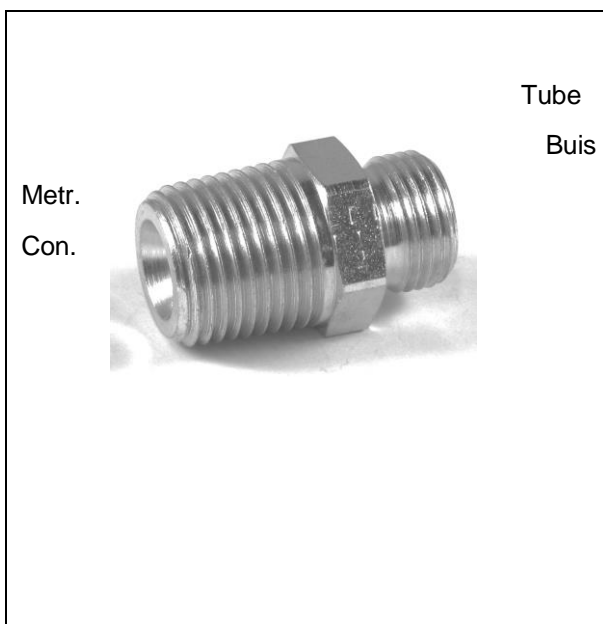

|  |
|--|
|  |
|  |
|  |
|  |
|  |
|  |
|  |
|  |

\* Standaard verzinkt, ook leverbaar in RVS – standard zingué, aussi livrable en inox

# SNIJRINGKOPPELINGEN / RACCORDS A BAGUE COUPANTE

## KOPPELING MET NPT BUITENDRAAD RACCORD AVEC FILET EXTERIEUR NPT

### GEV.....NPT

| Art.N°           | Buitendiam.<br>buis<br>Ø extérieur<br>tube | NPT      |
|------------------|--|----------|
| GEV 04LL 1/8NPT  | 4  | 1/8NPT   |
| GEV 05LL 1/8NPT  | 5  | 1/8NPT   |
| GEV 06LL 1/8NPT  | 6  | 1/8NPT   |
| GEV 08LL 1/8NPT  | 8  | 1/8NPT   |
| GEV 06L 1/8NPT   | 6  | 1/8NPT   |
| GEV 06L 1/4NPT   | 6  | 1/4NPT   |
| GEV 08L 1/8NPT   | 8  | 1/8NPT   |
| GEV 08L 1/4NPT   | 8  | 1/4NPT   |
| GEV 08L 3/8NPT   | 8  | 3/8NPT   |
| GEV 10L 1/8NPT   | 8  | 1/8NPT   |
| GEV 10L 3/8NPT   | 10   | 3/8NPT   |
| GEV 10L 1/2NPT   | 10   | 1/2NPT   |
| GEV 12L 1/4NPT   | 12   | 1/4NPT   |
| GEV 12L 3/8NPT   | 12   | 3/8NPT   |
| GEV 12L 1/2NPT   | 12   | 1/2NPT   |
| GEV 15L 3/8NPT   | 15   | 3/8NPT   |
| GEV 15L 1/2NPT   | 15   | 1/2NPT   |
| GEV 18L 1/2NPT   | 18   | 1/2NPT   |
| GEV 18L 3/4NPT   | 18   | 3/4NPT   |
| GEV 22L 3/4NPT   | 22   | 3/4NPT   |
| GEV 28L 1NPT     | 28   | 1NPT     |
| GEV 35L 1NPT     | 35   | 1NPT     |
| GEV 35L 1 1/4NPT | 35   | 1 1/4NPT |
| GEV 42L 1 1/2NPT | 42   | 1 1/2NPT |



NPT

Buis  
Tube

|                  |    |          |
|------------------|----|----------|
| GEV 06S 1/4NPT   | 6  | 1/4NPT   |
| GEV 08S 1/4NPT   | 8  | 1/4NPT   |
| GEV 10S 1/4NPT   | 10 | 1/4NPT   |
| GEV 10S 3/8NPT   | 10 | 3/8NPT   |
| GEV 12S 1/4NPT   | 12 | 1/4NPT   |
| GEV 12S 3/8NPT   | 12 | 3/8NPT   |
| GEV 12S 1/2NPT   | 12 | 1/2NPT   |
| GEV 14S 1/2NPT   | 14 | 1/2NPT   |
| GEV 16S 1/2NPT   | 16 | 1/2NPT   |
| GEV 20S 3/4NPT   | 20 | 3/4NPT   |
| GEV 25S 1NPT     | 25 | 1NPT     |
| GEV 30S NPT      | 30 | 1NPT     |
| GEV 30S 1 1/4NPT | 30 | 1 1/4NPT |
| GEV 38S 1 1/2NPT | 38 | 1 1/2NPT |

\* Standaard verzinkt, ook leverbaar in RVS – standard zingué, aussi livrable en inox

# SNIJRINGKOPPELINGEN / RACCORDS A BAGUE COUPANTE

## KOPPELING MET ORFS DRAAD RACCORD AVEC FILET ORFS

### GEV.....ORM

| Art.N°        | Buitendiam.<br>buis<br>Ø extérieur<br>tube | ORFS       |
|---------------|--|------------|
| GEV 06L 04ORM | 6  | 9/16-18    |
| GEV 08L 04ORM | 8  | 9/16-18    |
| GEV 10L 06ORM | 10   | 11/16-16   |
| GEV 12L 08ORM | 12   | 13/16-16   |
| GEV 15L 10ORM | 15   | 1-14       |
| GEV 18L 12ORM | 18   | 1 3/16-12  |
| GEV 22L 16ORM | 16   | 1 7/16-12  |
| GEV 28L 20ORM | 28   | 1 11/16-12 |
| GEV 35L 24ORM | 35   | 2-12       |
| GEV 42L 24ORM | 42   | 2-12       |
|               |  |            |
|               |  |            |
|               |  |            |
|               |  |            |
|               |  |            |
|               |  |            |

Buis  
Tube

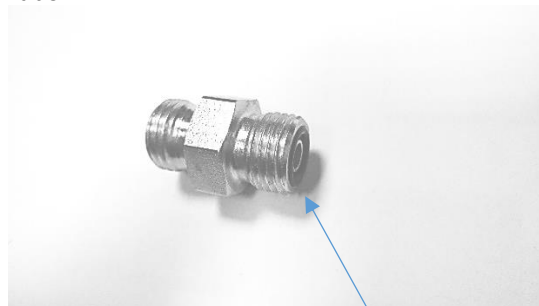

ORFS

|               |    |            |
|---------------|----|------------|
| GEV 06S 04ORM | 6  | 9/16-18    |
| GEV 08S 04ORM | 8  | 9/16-18    |
| GEV 10S 06ORM | 10 | 11/16-16   |
| GEV 12S 08ORM | 12 | 13/16-16   |
| GEV 14S 10ORM | 14 | 1-14       |
| GEV 16S 10ORM | 16 | 1-14       |
| GEV 20S 12ORM | 20 | 1 3/16-12  |
| GEV 25S 16ORM | 25 | 1 7/16-12  |
| GEV 30S 20ORM | 30 | 1 11/16-12 |
| GEV 38S 24ORM | 38 | 2-12       |

\* Standaard verzinkt, ook leverbaar in RVS – standard zingué, aussi livrable en inox



## SNIJRINGKOPPELINGEN / RACCORDS A BAGUE COUPANTE

## KOPPELING MET BSP BUITENDRAAD / RACCORD AVEC FILET EXTERIEUR BSP

GEV.....R

| Art.N°        | Buitendiam. buis<br>Ø extérieur tube | G     |
|---------------|--------------------------------------|-------|
| GEV 04LL R1/8 | 4                                    | G 1/8 |
| GEV 06LL R1/8 | 6                                    | G 1/8 |
| GEV 08LL R1/8 | 8                                    | G 1/8 |
| GEV 06L R1/8  | 6                                    | G 1/8 |
| GEV 06L R1/4  | 6                                    | G 1/4 |
| GEV 06L R3/8  | 6                                    | G 3/8 |
| GEV 06L R1/2  | 6                                    | G 1/2 |
| GEV 08L R1/8  | 8                                    | G 1/8 |
| GEV 08L R1/4  | 8                                    | G 1/4 |
| GEV 08L R3/8  | 8                                    | G 3/8 |
| GEV 08L R1/2  | 8                                    | G 1/2 |
| GEV 10L R1/8  | 10                                   | G 1/8 |
| GEV 10L R1/4  | 10                                   | G 1/4 |
| GEV 10L R3/8  | 10                                   | G 3/8 |
| GEV 10L R1/2  | 10                                   | G 1/2 |
| GEV 12L R1/8  | 12                                   | G 1/8 |
| GEV 12L R1/4  | 12                                   | G 1/4 |
| GEV 12L R3/8  | 12                                   | G 3/8 |
| GEV 12L R1/2  | 12                                   | G 1/2 |
| GEV 12L R3/4  | 12                                   | G 3/4 |
| GEV 13L R1/4  | 13                                   | G 1/4 |
| GEV 13L R3/8  | 13                                   | G 3/8 |
| GEV 13L R1/2  | 13                                   | G 1/2 |
| GEV 15L R1/4  | 15                                   | G 1/4 |
| GEV 15L R3/8  | 15                                   | G 3/8 |
| GEV 15L R1/2  | 15                                   | G 1/2 |
| GEV 15L R3/4  | 15                                   | G 3/4 |
| GEV 17L R3/8  | 17                                   | G 3/8 |
| GEV 17L R1/2  | 17                                   | G 1/2 |
| GEV 18L R3/8  | 18                                   | G 3/8 |
| GEV 18L R1/2  | 18                                   | G 1/2 |
| GEV 18L R3/4  | 18                                   | G 3/4 |
| GEV 18L R1"   | 18                                   | G 1"  |
| GEV 21L R1/2  | 21                                   | G 1/2 |
| GEV 21L R3/4  | 21                                   | G 3/4 |
| GEV 22L R1/2  | 22                                   | G 1/2 |
| GEV 22L R3/4  | 22                                   | G 3/4 |
| GEV 22L R1"   | 22                                   | G 1"  |
| GEV 27L R3/4  | 27                                   | G 3/4 |
| GEV 27L R1"   | 27                                   | G 1"  |

[illegible]

\* Standaard verzinkt, ook leverbaar in RVS – standard zingué, aussi livrable en inox

# SNIJRINGKOPPELINGEN / RACCORDS A BAGUE COUPANTE

## KOPPELING MET BSP BUITENDRAAD / RACCORD AVEC FILET EXTERIEUR BSP

| GEV.....R    | VERVOLG / SUITE                      |       |
|--------------|--------------------------------------|-------|
| Art.N°       | Buitendiam. buis<br>Ø extérieur tube | G     |
| GEV 06S R1/4 | 6                                    | G 1/4 |
| GEV 06S R3/8 | 6                                    | G 3/8 |
| GEV 06S R1/2 | 6                                    | G 1/2 |
| GEV 08S R1/4 | 8                                    | G 1/4 |
| GEV 08S R3/8 | 8                                    | G 3/8 |
| GEV 08S R1/2 | 8                                    | G 1/2 |
| GEV 10S R1/4 | 10                                   | G 1/4 |
| GEV 10S R3/8 | 10                                   | G 3/8 |
| GEV 10S R1/2 | 10                                   | G 1/2 |
| GEV 12S R1/4 | 12                                   | G 1/4 |
| GEV 12S R3/8 | 12                                   | G 3/8 |
| GEV 12S R1/2 | 12                                   | G 1/2 |
| GEV 14S R3/8 | 14                                   | G 3/8 |
| GEV 14S R1/2 | 14                                   | G 1/2 |
| GEV 14S R3/4 | 14                                   | G 3/4 |
| GEV 16S R3/8 | 16                                   | G 3/8 |
| GEV 16S R1/2 | 16                                   | G 1/2 |
| GEV 16S R3/4 | 16                                   | G 3/4 |
| GEV 20S R1/2 | 20                                   | G 1/2 |



Buis  
Tube

|                |    |         |
|----------------|----|---------|
| GEV 20S R3/4   | 20 | G 3/4   |
| GEV 20S R1"    | 20 | G 1"    |
| GEV 25S R1/2   | 25 | G 1/2   |
| GEV 25S R3/4   | 25 | G 3/4   |
| GEV 25S R1     | 25 | G 1"    |
| GEV 25S R1 1/4 | 25 | G 1 1/4 |
| GEV 30S R3/4   | 30 | G 3/4   |
| GEV 30S R1"    | 30 | G 1"    |
| GEV 30S R1 1/4 | 30 | G 1 1/4 |
| GEV 38S R1"    | 38 | G 1"    |
| GEV 38S R1 1/4 | 38 | G 1 1/4 |
| GEV 38S R1 1/2 | 38 | G 1 1/2 |

\* Standaard verzinkt, ook leverbaar in RVS – standard zingué, aussi livrable en inox

# SNIJRINGKOPPELINGEN / RACCORDS A BAGUE COUPANTE

## KOPPELING MET CONISCHE BSP BUITENDRAAD RACCORD AVEC FILET EXTERIEUR BSP CONIQUE

### GEV.....RK

| Art.N°         | Buitendiam.buis<br>Ø extérieur tube | G<br>con. |
|----------------|-------------------------------------|-----------|
| GEV 04LL RK1/8 | 4                                   | G 1/8     |
| GEV 05LL RK1/8 | 5                                   | G 1/8     |
| GEV 06LL RK1/8 | 6                                   | G 1/8     |
| GEV 06LL RK1/4 | 6                                   | G 1/4     |
| GEV 08LL RK1/8 | 8                                   | G 1/8     |
| GEV 08LL RK1/4 | 8                                   | G 1/4     |
| GEV 10LL RK1/4 | 10                                  | G 1/4     |
|                |                                     |           |
| GEV 06L RK1/8  | 6                                   | G 1/8     |
| GEV 06L RK1/4  | 6                                   | G 1/4     |
| GEV 08L RK1/8  | 8                                   | G 1/8     |
| GEV 08L RK1/4  | 8                                   | G 1/4     |
| GEV 08L RK3/8  | 8                                   | G 3/8     |
| GEV 08L RK1/2  | 8                                   | G 1/2     |
| GEV 10L RK1/8  | 10                                  | G 1/8     |
| GEV 10L RK1/4  | 10                                  | G 1/4     |
| GEV 10L RK3/8  | 10                                  | G 3/8     |
| GEV 12L RK1/4  | 12                                  | G 1/4     |
| GEV 12L RK3/8  | 12                                  | G 3/8     |
| GEV 12L RK1/2  | 12                                  | G 1/2     |
| GEV 13L RK1/4  | 13                                  | G 1/4     |
| GEV 13L RK3/8  | 13                                  | G 3/8     |
| GEV 13L RK1/2  | 13                                  | G 1/2     |
| GEV 15L RK3/8  | 15                                  | G 3/8     |
| GEV 15L RK1/2  | 15                                  | G 1/2     |
| GEV 17L RK1/4  | 17                                  | G 1/4     |
| GEV 17L RK3/8  | 17                                  | G 3/8     |
| GEV 17L RK1/2  | 17                                  | G 1/2     |
| GEV 18L RK1/2  | 18                                  | G 1/2     |
| GEV 18L RK3/4  | 18                                  | G 3/4     |

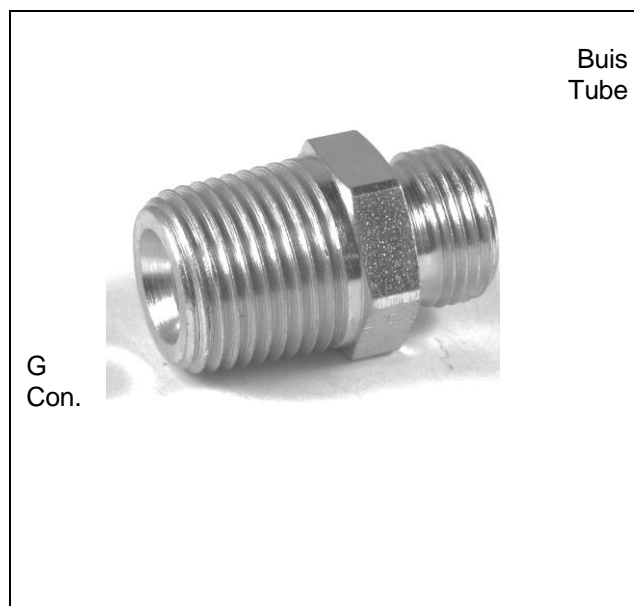

|                 |    |         |
|-----------------|----|---------|
| GEV 21L RK1/2   | 21 | G 1/2   |
| GEV 21L RK3/4   | 21 | G 3/4   |
| GEV 22L RK3/4   | 22 | G 3/4   |
| GEV 27L RK3/4   | 27 | G 3/4   |
| GEV 27L RK1"    | 27 | G 1"    |
| GEV 33L RK1"    | 33 | G 1"    |
| GEV 33L RK1 1/4 | 33 | G 1"1/4 |
| GEV 35L RK1 1/4 | 35 | G 1"1/4 |
|                 |    |         |
| GEV 06S RK1/4   | 6  | G 1/4   |
| GEV 08S RK1/4   | 8  | G 1/4   |
| GEV 12S RK1/4   | 12 | G 1/4   |
| GEV 12S RK3/8   | 12 | G 3/8   |
| GEV 16S RK3/8   | 16 | G 3/8   |
| GEV 16S RK1/2   | 16 | G 1/2   |
| GEV 20S RK1/2   | 20 | G 1/2   |
| GEV 20S RK3/4   | 20 | G 3/4   |
| GEV 25S RK3/4   | 25 | G 3/4   |
| GEV 25S RK1"    | 25 | G 1"    |
| GEV 30S RK1"    | 30 | G 1"    |
| GEV 30S RK1 1/4 | 30 | G 1"1/4 |

Standaard verzinkt, ook leverbaar in RVS – standard zingué, aussi livrable en inox

# SNIJRINGKOPPELINGEN / RACCORDS A BAGUE COUPANTE

## KOPPELING MET SAE BUITENDRAAD RACCORD AVEC FILET EXTERIEUR SAE

### GEV.....UNF

| Art.N°               | Buitendiam<br>buis<br>Ø extérieur<br>tube | O-ring       |
|----------------------|---|--------------|
| GEV 06L 7/16 20UNF   | 6   | 8,92 x 1,83  |
| GEV 08L 7/16 20UNF   | 8   | 8,92 x 1,83  |
| GEV 08L 1/2 20UNF    | 8   | 10,51 x 1,83 |
| GEV 08L 9/16 18UNF   | 8   | 11,9 x 1,98  |
| GEV 10L 7/16 20UNF   | 10  | 8,92 x 1,83  |
| GEV 10L 9/16 18UNF   | 10  | 11,9 x 1,98  |
| GEV 10L 3/4 16UNF    | 10  | 16,36 x 2,20 |
| GEV 12L 9/16 18UNF   | 12  | 11,9 x 1,98  |
| GEV 12L 3/4 16UNF    | 12  | 16,36 x 2,20 |
| GEV 12L 7/8 14UNF    | 12  | 19,18 x 2,46 |
| GEV 15L 9/16 18UNF   | 15  | 11,9 x 1,98  |
| GEV 15L 3/4 16UNF    | 15  | 16,36 x 2,20 |
| GEV 15L 7/8 14UNF    | 15  | 19,18 x 2,46 |
| GEV 17L 7/8 14UNF    | 17  | 19,18 x 2,46 |
| GEV 18L 3/4 16UNF    | 18  | 16,36 x 2,20 |
| GEV 18L 7/8 14UNF    | 18  | 19,18 x 2,46 |
| GEV 22L 7/8 14UNF    | 22  | 19,18 x 2,46 |
| GEV 22L 1"1/16 12UNF | 22  | 23,47 x 2,95 |
| GEV 22L 1"5/16 12UNF | 22  | 29,74 x 2,95 |
| GEV 28L 1"5/16 12UNF | 28  | 29,74 x 2,95 |
| GEV 35L 1 5/16 12UNF | 35  | 29,74 x 2,95 |



|                      |    |              |
|----------------------|----|--------------|
| GEV 08S 7/16 20UNF   | 8  | 8,92 x 1,83  |
| GEV 12S 9/16 18UNF   | 12 | 11,9 x 1,98  |
| GEV 12S 3/4 16UNF    | 12 | 16,36 x 2,20 |
| GEV 16S 3/4 16UNF    | 16 | 16,36 x 2,20 |
| GEV 16S 7/8 14UNF    | 16 | 19,18 x 2,46 |
| GEV 20S 3/4 16UNF    | 20 | 16,36 x 2,20 |
| GEV 20S 7/8 14UNF    | 20 | 19,18 x 2,46 |
| GEV 20S 1"1/16 12UNF | 20 | 23,47 x 2,95 |
| GEV 25S 1"5/16 12UNF | 25 | 29,74 x 2,95 |
| GEV 30S 1"5/8 12UNF  | 30 | 37,46 x 3    |

\* Standaard verzinkt, ook leverbaar in RVS – standard zingué, aussi livrable en inox

# SNIJRINGKOPPELINGEN / RACCORDS A BAGUE COUPANTE

## KOPPELING VOOR SCHOTDOORVOER RACCORD PASSE-CLOISON

### GSV.....

| Art.N°  | Buitendiam<br>buis<br>Ø extérieur<br>tube | D<br>min | D<br>max | M       |
|---------|---|----------|----------|---------|
| GSV 06L | 6   | 4        | 16       | M12x1,5 |
| GSV 08L | 8   | 4        | 16       | M14x1,5 |
| GSV 10L | 10  | 4        | 16       | M16x1,5 |
| GSV 12L | 12  | 4        | 16       | M18x1,5 |
| GSV 13L | 13  | 4        | 16       | M20x1,5 |
| GSV 15L | 15  | 4        | 16       | M22x1,5 |
| GSV 17L | 17  | 4        | 16       | M24x1,5 |
| GSV 18L | 18  | 4        | 16       | M26x1,5 |
| GSV 21L | 21  | 4        | 16       | M30x1,5 |
| GSV 22L | 22  | 5        | 16       | M30x2   |
| GSV 27L | 27  | 5        | 16       | M36x1,5 |
| GSV 28L | 28  | 5        | 16       | M36x2   |
| GSV 33L | 33  | 5        | 16       | M45x1,5 |
| GSV 35L | 35  | 5        | 16       | M45x2   |
| GSV 42L | 42  | 5        | 16       | M52x2   |

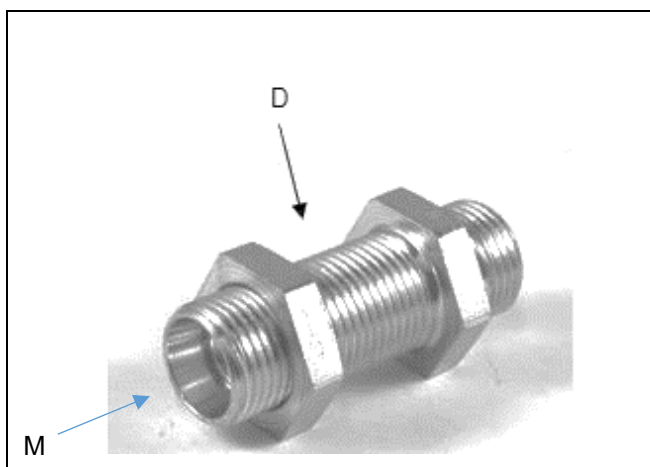

|         |    |   |    |         |
|---------|----|---|----|---------|
| GSV 06S | 6  | 4 | 16 | M14x1,5 |
| GSV 08S | 8  | 4 | 16 | M16x1,5 |
| GSV 10S | 10 | 4 | 16 | M18x1,5 |
| GSV 12S | 12 | 4 | 16 | M20x1,5 |
| GSV 14S | 14 | 4 | 16 | M22x1,5 |
| GSV 16S | 16 | 4 | 16 | M24x1,5 |
| GSV 20S | 20 | 5 | 16 | M30x2   |
| GSV 25S | 25 | 5 | 16 | M36x2   |
| GSV 30S | 30 | 5 | 16 | M42x2   |
| GSV 38S | 38 | 5 | 16 | M52x2   |

\* Standaard verzinkt, ook leverbaar in RVS – standard zingué, aussi livrable en inox

## SNIJRINGKOPPELINGEN / RACCORDS A BAGUE COUPANTE

### SCHOTDOORVOER MET BSP BUITENDRAAD RACCORD PASSE-CLOISON AVEC FILET EXTERIEUR BSP

| GESV—R-         | Metr. | BSP   |
|-----------------|-------|-------|
| Art.N°          | 1     | 2     |
| GESV 06L R1/8   | 06    | 1/8   |
| GESV 06L R1/4   | 06    | 1/4   |
| GESV 08L R1/4   | 08    | 1/4   |
| GESV 08L R3/8   | 08    | 3/8   |
| GESV 08L R1/2   | 08    | 1/2   |
| GESV 10L R1/4   | 10    | 1/4   |
| GESV 10L R1/2   | 10    | 1/2   |
| GESV 12L R1/4   | 12    | 1/4   |
| GESV 12L R3/8   | 12    | 3/8   |
| GESV 12L R1/2   | 12    | 1/2   |
| GESV 15L R1/2   | 15    | 1/2   |
| GESV 15L R3/4   | 15    | 3/4   |
| GESV 18L R1/2   | 18    | 1/2   |
| GESV 18L R3/4   | 18    | 3/4   |
| GESV 18L R1     | 18    | 1     |
| GESV 22L R1     | 11    | 1     |
| GESV 22L R3/4   | 22    | 3/4   |
| GESV 28L R3/4   | 28    | 3/4   |
| GESV 28L R1     | 28    | 1     |
| GESV 28L R1 1/4 | 38    | 1"1/4 |
| GESV 35L R1 1/4 | 35    | 1"1/4 |
| GESV 35L R1 1/2 | 35    | 1"1/2 |
| GESV 42L R1 1/4 | 42    | 1"1/4 |
| GESV 42L R1 1/2 | 42    | 1"1/2 |

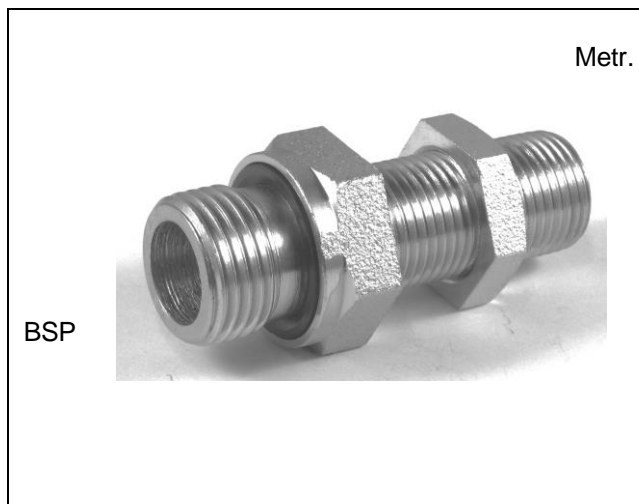

BSP

Metr.

|                 |    |       |
|-----------------|----|-------|
| GESV 10S R3/8   | 10 | 3/8   |
| GESV 10S R1/2   | 10 | 1/2   |
| GESV 12S R3/8   | 12 | 3/8   |
| GESV 12S R1/2   | 12 | 1/2   |
| GESV 14S R1/2   | 14 | 1/2   |
| GESV 16S R1/2   | 16 | 1/2   |
| GESV 16S R3/4   | 16 | 3/4   |
| GESV 20S R1/2   | 20 | 1/2   |
| GESV 20S R3/4   | 20 | 3/4   |
| GESV 20S R1     | 20 | 1     |
| GESV 25S R3/4   | 25 | 3/4   |
| GESV 25S R1     | 25 | 1"    |
| GESV 25S R1 1/4 | 25 | 1"1/4 |
| GESV 30S R1     | 30 | 1"    |
| GESV 30S R1 1/4 | 30 | 1"1/4 |
| GESV 38S R1 1/4 | 38 | 1"1/4 |
| GESV 38S R1 1/2 | 38 | 1"1/2 |

Standaard verzinkt, ook leverbaar in RVS – standard zingué, aussi livrable en inox

## SNIJRINGKOPPELINGEN / RACCORDS A BAGUE COUPANTE

### SCHOTDOORVOER MET METRISCHE BUITENDRAAD RACCORD PASSE-CLOISON AVEC FILET EXTERIEUR METRIQUE

| GESVM            | Metr. | METR.   |
|------------------|-------|---------|
| Art.N°           | 1     | 2       |
| GESV 10L M16x1,5 | 10    | M16x1,5 |
| GESV 10L M22x1,5 | 10    | M22x1,5 |
| GESV 12L M16x1,5 | 12    | M16x1,5 |
| GESV 12L M22x1,5 | 12    | M22x1,5 |
|                  |       |         |
|                  |       |         |
|                  |       |         |

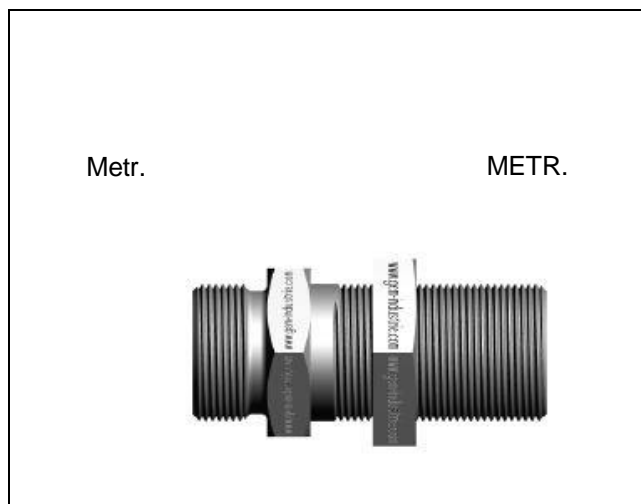

\* Standaard verzinkt, ook leverbaar in RVS – standard zingué, aussi livrable en inox

## SNIJRINGKOPPELINGEN / RACCORDS A BAGUE COUPANTE

| <b>KM-</b>  | <b>MOER voor schotdoorvoer<br/>ECROU pour passe-cloison</b> |
|-------------|---|
| Art.N°      | Draad / filet<br>mm   |
| KM 12 x 1,5 | 12 x 1,5  |
| KM 14 x 1,5 | 14 x 1,5  |
| KM 18 x 1,5 | 18 x 1,5  |
| KM 20 x 1,5 | 20 x 1,5  |
| KM 22 x 1,5 | 22 x 1,5  |
| KM 24 x 1,5 | 24 x 1,5  |
| KM 26 x 1,5 | 26 x 1,5  |
| KM 30 x 2   | 30 x 2  |



|           |        |
|-----------|--------|
| KM 36 x 2 | 36 x 2 |
| KM 52 x 2 | 52 x 2 |

\* Standaard verzinkt, ook leverbaar in RVS – standard zingué, aussi livrable en inox



## SNIJRINGKOPPELINGEN / RACCORDS A BAGUE COUPANTE

### RECHTE VERBINDING / UNION DROIT

#### GV.....

| Art.N°  | Buitendiam.buis<br>Ø extérieur tube |
|---------|-------------------------------------|
| GV 04LL | 4                                   |
| GV 05LL | 5                                   |
| GV 06LL | 6                                   |
| GV 08LL | 8                                   |
| GV 10LL | 10                                  |
| GV 12LL | 12                                  |
| GV 16LL | 16                                  |
|         |                                     |
| GV 06L  | 6                                   |
| GV 08L  | 8                                   |
| GV 10L  | 10                                  |
| GV 12L  | 12                                  |
| GV 13L  | 13                                  |
| GV 15L  | 15                                  |
| GV 17L  | 17                                  |
| GV 18L  | 18                                  |
| GV 21L  | 21                                  |
| GV 22L  | 22                                  |
| GV 27L  | 27                                  |
| GV 28L  | 28                                  |
| GV 33L  | 33                                  |
| GV 35L  | 35                                  |
| GV 42L  | 42                                  |



|        |    |
|--------|----|
| GV 06S | 6  |
| GV 08S | 8  |
| GV 10S | 10 |
| GV 12S | 12 |
| GV 14S | 14 |
| GV 16S | 16 |
| GV 20S | 20 |
| GV 25S | 25 |
| GV 30S | 30 |
| GV 38S | 38 |
|        |    |
|        |    |
|        |    |
|        |    |
|        |    |

Standaard verzinkt, ook leverbaar in RVS – standard zingué, aussi livrable en inox

## SNIJRINGKOPPELINGEN / RACCORDS A BAGUE COUPANTE

## RECHTE VERBINDING / UNION DROIT

**EGV..... mannelijk/vrouwelijk**  
**mâle/femelle**

Art.N°

Buitendiam.buis  
Ø extérieur tube

[illegible]

|            |    |
|------------|----|
| EGV 06S SV | 6  |
| EGV 08S SV | 8  |
| EGV 10S SV | 10 |
| EGV 12S SV | 12 |
| EGV 14S SV | 14 |
| EGV 16S SV | 16 |
| EGV 20S SV | 20 |
| EGV 25S SV | 25 |
| EGV 30S SV | 30 |
| EGV 38S SV | 38 |
|            |    |
|            |    |
|            |    |
|            |    |

\* Standaard verzinkt, ook leverbaar in RVS – standard zingué, aussi livrable en inox

# SNIJRINGKOPPELINGEN / RACCORDS A BAGUE COUPANTE

## REDUCTIEKOPPELING / REDUCTION

### GV.../...

| Art.N°     | Buitendiam.<br>buis 1 | Buitendiam.<br>buis 2 |
|------------|-----------------------|-----------------------|
|            | Ø extérieur<br>tube 1 | Ø extérieur<br>tube 2 |
| GV 06/04LL | 6                     | 4                     |
| GV 08/06LL | 8                     | 6                     |
| GV 08/06L  | 8                     | 6                     |
| GV 10/06L  | 10                    | 6                     |
| GV 10/08L  | 10                    | 8                     |
| GV 12/06L  | 12                    | 6                     |
| GV 12/08L  | 12                    | 8                     |
| GV 12/10L  | 12                    | 10                    |
| GV 15/06L  | 15                    | 6                     |
| GV 15/08L  | 15                    | 8                     |
| GV 15/10L  | 15                    | 10                    |
| GV 15/12L  | 15                    | 12                    |
| GV 18/10L  | 18                    | 10                    |
| GV 18/12L  | 18                    | 12                    |
| GV 18/15L  | 18                    | 15                    |
| GV 22/10L  | 22                    | 10                    |
| GV 22/12L  | 22                    | 12                    |
| GV 22/15L  | 22                    | 15                    |
| GV 22/18L  | 22                    | 18                    |
| GV 28/15L  | 28                    | 15                    |
| GV 28/18L  | 28                    | 18                    |
| GV 28/22L  | 28                    | 22                    |
| GV 35/22L  | 35                    | 22                    |
| GV 35/28L  | 35                    | 28                    |
| GV 42/35L  | 42                    | 35                    |
| GV 08/06S  | 08                    | 06                    |
| GV 10/06S  | 10                    | 06                    |
| GV 10/08S  | 10                    | 08                    |

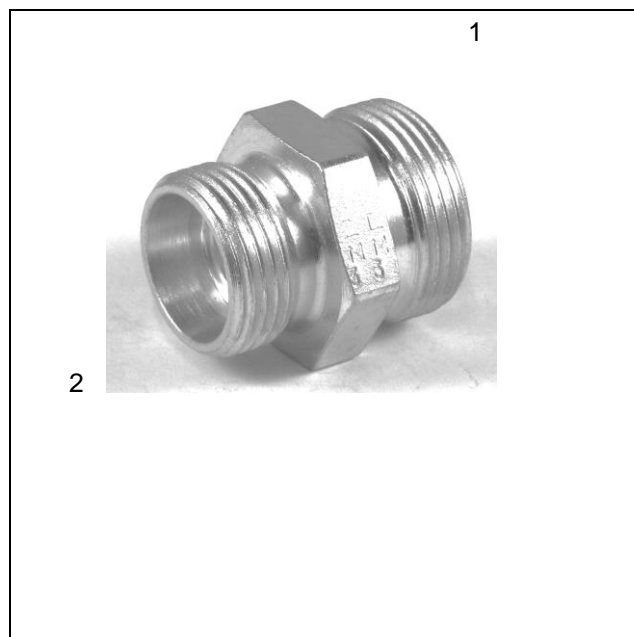

|           |    |    |
|-----------|----|----|
| GV 12/06S | 12 | 6  |
| GV 12/08S | 12 | 8  |
| GV 12/10S | 12 | 10 |
| GV 14/08S | 14 | 8  |
| GV 14/10S | 14 | 10 |
| GV 14/12S | 14 | 12 |
| GV 16/08S | 16 | 8  |
| GV 16/10S | 16 | 10 |
| GV 16/12S | 16 | 12 |
| GV 16/14S | 16 | 14 |
| GV 20/10S | 20 | 10 |
| GV 20/12S | 20 | 12 |
| GV 20/14S | 20 | 14 |
| GV 20/16S | 20 | 16 |
| GV 25/16S | 25 | 16 |
| GV 25/20S | 25 | 20 |
| GV 30/20S | 30 | 20 |
| GV 30/25S | 30 | 25 |
| GV 38/25S | 38 | 25 |
| GV 38/30S | 38 | 30 |

\* Standaard verzinkt, ook leverbaar in RVS – standard zingué, aussi livrable en inox

# SNIJRINGKOPPELINGEN / RACCORDS A BAGUE COUPANTE

## KRUISKOPPELING / CROISILLONS

| KV..... |                                     |
|---------|-------------------------------------|
| Art.N°  | Buitendiam.buis<br>Ø extérieur tube |
| KV 04LL | 4                                   |
| KV 06LL | 6                                   |
| KV 08LL | 8                                   |
|         |                                     |
| KV 06L  | 6                                   |
| KV 08L  | 8                                   |
| KV 10L  | 10                                  |
| KV 12L  | 12                                  |
| KV 15L  | 15                                  |
| KV 18L  | 18                                  |
| KV 22L  | 22                                  |
| KV 28L  | 28                                  |
| KV 35L  | 35                                  |
| KV 42L  | 42                                  |
|         |                                     |
|         |                                     |
|         |                                     |

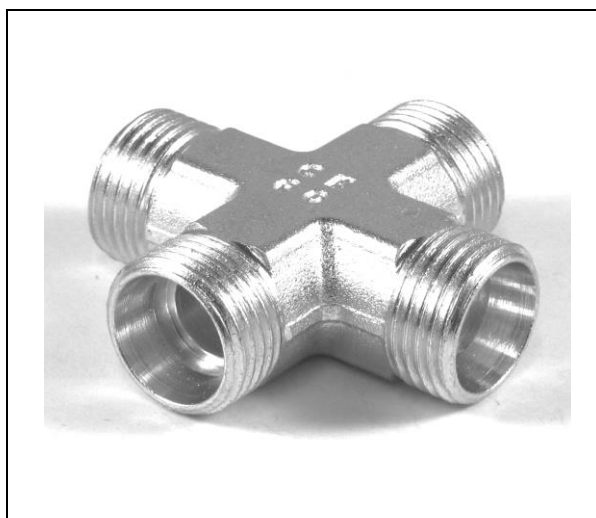

|        |    |
|--------|----|
| KV 06S | 6  |
| KV 08S | 8  |
| KV 10S | 10 |
| KV 12S | 12 |
| KV 14S | 14 |
| KV 16S | 16 |
| KV 20S | 20 |
| KV 25S | 25 |
| KV 30S | 30 |
| KV 38S | 38 |

\* Standaard verzinkt, ook leverbaar in RVS – standard zingué, aussi livrable en inox

## SNIJRINGKOPPELINGEN / RACCORDS A BAGUE COUPANTE

### LORF LASKOPPELING / RACCORD LORF A SOUDER

#### LAS-LORF- SAE vlakke zitting / siège plat

| Art.N°      | Buitendiam.buis<br>Ø extérieur tube |
|-------------|-------------------------------------|
| LAS04LORF06 | 6                                   |
| LAS06LORF08 | 8                                   |
| LAS06LORF10 | 10                                  |
| LAS08LORF12 | 12                                  |
| LAS10LORF15 | 15                                  |
| LAS10LORF16 | 16                                  |
| LAS12LORF18 | 18                                  |
| LAS12LORF20 | 20                                  |
| LAS16LORF25 | 25                                  |



|             |    |
|-------------|----|
| LAS20LORF30 | 30 |
| LAS24LORF38 | 38 |

### MOER VOOR LORF LASKOPPELING / ECROU POUR RACCORD LORF A SOUDER

#### M-LORF- Moer / écrou LORF

| Art.N°       | Draad<br>Filet | Buitendiam.<br>buis<br>Ø extérieur<br>tube |
|--------------|----------------|--|
| M04LORF06    | 9/16" x 18     | 6  |
| M06LORF08-10 | 11/16" x 16    | 8-10                                       |
| M08LORF12    | 13/16" x 16    | 12   |
| M10LORF14-16 | 1" x 14        | 14-16                                      |
| M12LORF18-20 | 1 3/16" x 12   | 18-20                                      |
| M16LORF22-25 | 1 7/16" x 12   | 22-25                                      |
| M20LORF28-32 | 1 11/16" x 12  | 28-32                                      |
| M24LORF35-38 | 2" x 12        | 35-38                                      |



Standaard verzinkt, ook leverbaar in RVS – standard zingué, aussi livrable en inox

## SNIJRINGKOPPELINGEN / RACCORDS A BAGUE COUPANTE

### "T" KOPPELING / RACCORD EN "T"

#### LEV.....M

| Art.N°          | Buitendiam. buis<br>Ø extérieur tube | M        |
|-----------------|--------------------------------------|----------|
| LEV 22L M26x1,5 | 22                                   | M 26x1,5 |
| LEV 28L M33x2   | 28                                   | M 33x2   |
| LEV 35L M42x2   | 35                                   | M 42x2   |
| LEV 42L M48x2   | 42                                   | M 48x2   |
| LEV 20S M27x2   | 20                                   | M 27x2   |
| LEV 25S M33x2   | 25                                   | M 33x2   |
| LEV 30S M42x2   | 30                                   | M 42x2   |
| LEV 38S M48x2   | 38                                   | M 48x2   |



M

#### LEV.....R

| Art.N°         | Buitendiam. buis<br>Ø extérieur tube | G       |
|----------------|--------------------------------------|---------|
| LEV 22L R3/4   | 22                                   | G 3/4   |
| LEV 28L R1     | 28                                   | G 1"    |
| LEV 35L R1 1/4 | 35                                   | G 1 1/4 |
| LEV 42L R1 1/2 | 42                                   | G 1 1/2 |
| LEV 20S R3/4   | 20                                   | G 3/4   |
| LEV 25S R1     | 25                                   | G 1"    |
| LEV 30S R1 1/4 | 30                                   | G 1 1/4 |
| LEV 38S R1 1/2 | 38                                   | G 1 1/2 |



G

Standaard verzinkt, ook leverbaar in RVS – standard zingué, aussi livrable en inox

## SNIJRINGKOPPELINGEN / RACCORDS A BAGUE COUPANTE

**"T" KOPPELING MET CONISCHE BSP BUITENDRAAD  
RACCORD EN "T" AVEC FILET EXTER. BSP CONIQUE**

### LEV.....RK

| Art.N°         | Buitendiam. buis<br>Ø extérieur tube | G-con. |
|----------------|--------------------------------------|--------|
| LEV 04LL RK1/8 | 4                                    | G 1/8  |
| LEV 06LL RK1/8 | 6                                    | G 1/8  |
| LEV 08LL RK1/8 | 8                                    | G 1/8  |
| LEV 06L RK1/8  | 6                                    | G 1/8  |
| LEV 08L RK1/4  | 8                                    | G 1/4  |
| LEV 10L RK1/4  | 10                                   | G 1/4  |
| LEV 12L RK3/8  | 12                                   | G 3/8  |
| LEV 15L RK1/2  | 15                                   | G 1/2  |
| LEV 18L RK1/2  | 18                                   | G 1/2  |
|                |                                      |        |
|                |                                      |        |
|                |                                      |        |
|                |                                      |        |

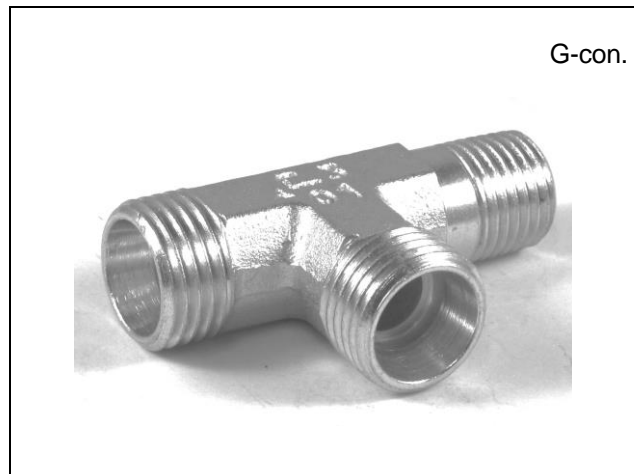

|               |    |       |
|---------------|----|-------|
| LEV 06S RK1/4 | 6  | G 1/4 |
| LEV 08S RK1/4 | 8  | G 1/4 |
| LEV 10S RK3/8 | 10 | G 3/8 |
| LEV 12S RK3/8 | 12 | G 3/8 |
| LEV 14S RK1/2 | 14 | G 1/2 |
| LEV 16S RK1/2 | 16 | G 1/2 |
|               |    |       |
|               |    |       |

Standaard verzinkt, ook leverbaar in RVS – standard zingué, aussi livrable en inox

# SNIJRINGKOPPELINGEN / RACCORDS A BAGUE COUPANTE

## MOER / ECROU

| M..... |                                     |          |
|--------|-------------------------------------|----------|
| Art.N° | Buitendiam.buis<br>Ø extérieur tube | M        |
| M 04LL | 4                                   | M 8x1    |
| M 05LL | 5                                   | M 10x1   |
| M 06LL | 6                                   | M 10x1   |
| M 08LL | 8                                   | M 12x1   |
| M 10LL | 10                                  | M 14x1   |
| M 12LL | 12                                  | M 16x1   |
| M 16LL | 16                                  | M 22x1,5 |
|        |                                     |          |
| M 06L  | 6                                   | M 12x1,5 |
| M 08L  | 8                                   | M 14x1,5 |
| M 10L  | 10                                  | M 16x1,5 |
| M 12L  | 12                                  | M 18x1,5 |
| M 13L  | 13                                  | M 20x1,5 |
| M 14L  | 14                                  | M 20x1,5 |
| M 15L  | 15                                  | M 22x1,5 |
| M 17L  | 17                                  | M 24x1,5 |
| M 18L  | 18                                  | M 26x1,5 |
| M 21L  | 21                                  | M 30x1,5 |
| M 22L  | 22                                  | M 30x2   |
| M 27L  | 27                                  | M 36x1,5 |
| M 28L  | 28                                  | M 36x2   |
| M 33 L | 33                                  | M 45x1,5 |
| M 35L  | 35                                  | M 45x2   |
| M 42L  | 42                                  | M 52x2   |

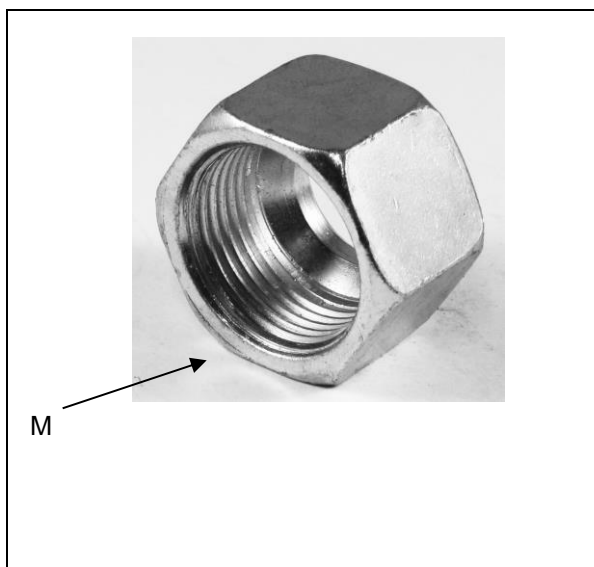

|       |    |          |
|-------|----|----------|
| M 06S | 6  | M 14x1,5 |
| M 08S | 8  | M 16x1,5 |
| M 10S | 10 | M 18x1,5 |
|       |    |          |
| M 12S | 12 | M 20x1,5 |
| M 14S | 14 | M 22x1,5 |
| M 16S | 16 | M 24x1,5 |
| M 20S | 20 | M 30x2   |
| M 25S | 25 | M 36x2   |
| M 30S | 30 | M 42x2   |
| M 38S | 38 | M 52x2   |

Standaard verzinkt, ook leverbaar in RVS – standard zingué, aussi livrable en inox



## SNIJRINGKOPPELINGEN / RACCORDS A BAGUE COUPANTE

### MOER VOOR BUIS SAE 37° / ECROU POUR TUBE SAE 37°

| M.....JF..... | JIC            |                                      |
|---------------|----------------|--------------------------------------|
| Art.N°        | Draad<br>Filet | Buitendiam. buis<br>Ø extérieur tube |
| M 07JF06      | 7/16-20        | 6                                    |
| M 08JF08      | 1/2-20         | 8                                    |
| M 09JF10      | 9/16-18        | 10                                   |
| M 12JF12      | 3/4-16         | 12                                   |
| M 14JF14-16   | 7/8-14         | 14                                   |
| M 14JF14-16   | 7/8-14         | 15                                   |
| M 14JF14-16   | 7/8-14         | 16                                   |
| M 17JF18-20   | 1"1/16-12      | 18                                   |
| M 17JF18-20   | 1"1/16-12      | 20                                   |
| M 19JF22      | 1"3/16-12      | 22                                   |
| M 21JF25      | 1"5/16-12      | 25                                   |
| M 26JF30-32   | 1"5/8-12       | 30                                   |
| M 26JF30-32   | 1"5/8-12       | 32                                   |
| M 30JF38      | 1"7/8-12       | 38                                   |
|               |                |                                      |
|               |                |                                      |
|               |                |                                      |

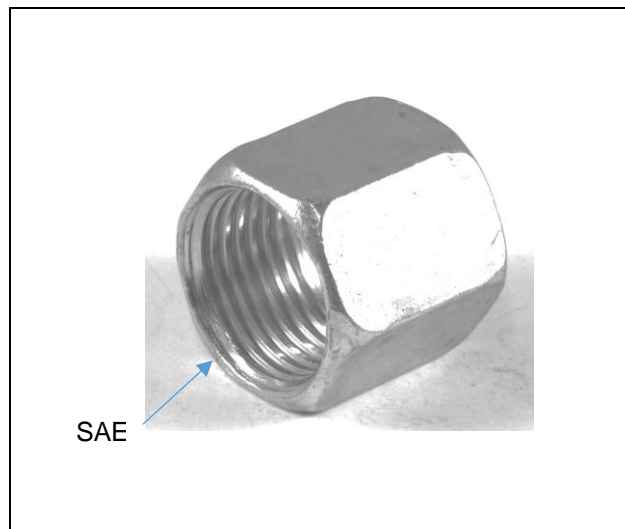

Standaard verzinkt, ook leverbaar in RVS – standard zingué, aussi livrable en inox

## SNIJRINGKOPPELINGEN / RACCORDS A BAGUE COUPANTE

### MANOMETERKOPPELING MET BSP BINNENDR RACCORD POUR MANOMETRE AVEC FILET INTER. BSP

#### MAV.....R

| Art.N°       | Buitendiam. buis<br>Ø extérieur tube | G     |
|--------------|--------------------------------------|-------|
| MAV 06L R1/4 | 6                                    | G 1/4 |
| MAV 08L R1/4 | 8                                    | G 1/4 |
| MAV 10L R1/4 | 10                                   | G 1/4 |
| MAV 12L R1/4 | 12                                   | G 1/4 |
| MAV 06S R1/2 | 6                                    | G 1/2 |
| MAV 08S R1/2 | 8                                    | G 1/2 |
| MAV 10S R1/2 | 10                                   | G 1/2 |
| MAV 12S R1/2 | 12                                   | G 1/2 |
|              |                                      |       |
|              |                                      |       |
|              |                                      |       |
|              |                                      |       |
|              |                                      |       |

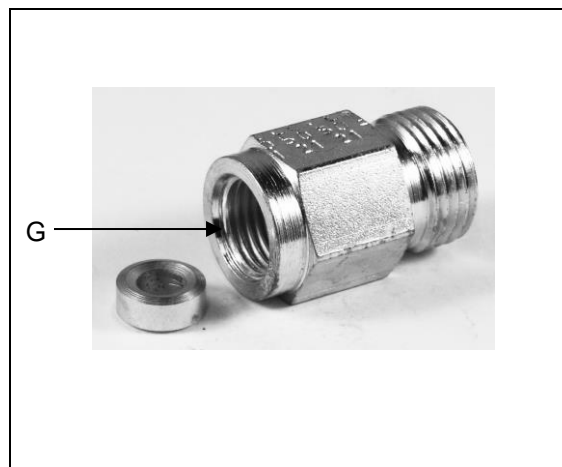

### DICHTINGSRING O-RING

#### DKI-R

| Art.N°   | D1 | D2 | L1  |
|----------|----|----|-----|
| DKI R1/4 | 6  | 11 | 4,5 |
| DKI R1/2 | 9  | 18 | 5   |
|          |    |    |     |
|          |    |    |     |
|          |    |    |     |
|          |    |    |     |

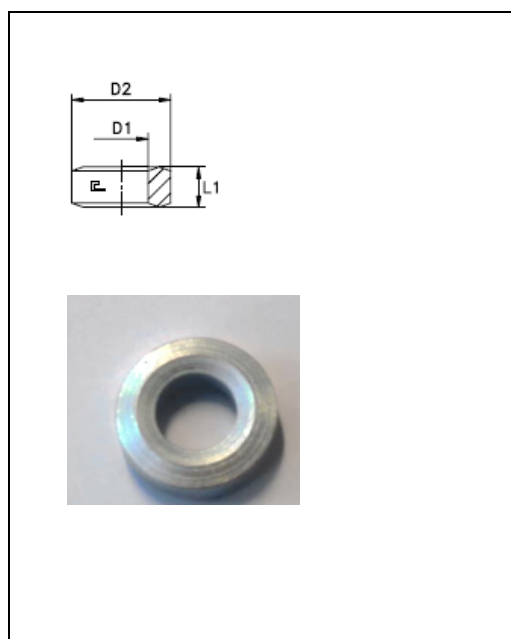

Standaard verzinkt, ook leverbaar in RVS – standard zingué, aussi livrable en inox

## SNIJRINGKOPPELINGEN / RACCORDS A BAGUE COUPANTE

### KOPPELING MET METRISCHE BINNENDRAAD RACCORD AVEC FILET INTERIEUR METRIQUE

| NV--       |       | Metr.    | Metr.    |
|------------|-------|----------|----------|
| Art.N°     | A     | 1        | 2        |
| NV06L      | 6     | 12 x 1,5 | 12 x 1,5 |
| NV08L      | 8     | 14 x 1,5 | 14 x 1,5 |
| NV 08L/06L | 08/06 | 14 X 1,5 | 12 x 1,5 |
| NV10L      | 10    | 16 x 1,5 | 16 x 1,5 |
| NV 10L/08L | 10/08 | 16 x 1,5 | 14 x 1,5 |
| NV12L      | 12    | 18 x 1,5 | 18 x 1,5 |
| NV12L/08L  | 12/08 | 18 x 1,5 | 14 x 1,5 |
| NV12L/10L  | 12/10 | 18 x 1,5 | 16 x 1,5 |
| NV12L/08S  | 12/08 | 18 x 1,5 | 16 x 1,5 |
| NV15L      | 15    | 22 x 1,5 | 22 x 1,5 |
| NV15L/12L  | 15/12 | 22 x 1,5 | 18 x 1,5 |
| NV15L/12S  | 15/12 | 22 x 1,5 | 20 x 1,5 |
| NV18L      | 18    | 26 x 1,5 | 26 x 1,5 |
| NV18L/15L  | 18/12 | 26 x 1,5 | 18 x 1,5 |
| NV22L      | 22    | 30 x 2,0 | 30 x 2,0 |
| NV 22L/16S | 22/16 | 30 x 2,0 | 24 x 1,5 |
| NV22L/18L  | 22/18 | 30 x 2,0 | 26 x 1,5 |
| NV28L      | 28    | 36 x 2,0 | 36 x 2,0 |
| NV35L      | 35    | 45 x 2,0 | 45 x 2,0 |
| NV42L      | 42    | 52 x 2,0 | 52 x 2,0 |
| NV06S      | 6     | 14 x 1,5 | 14 x 1,5 |
| NV08S      | 8     | 16 x 1,5 | 16 x 1,5 |
| NV08S/08L  | 8     | 16 x 1,5 | 14 x 1,5 |
| NV10S      | 10    | 18 x 1,5 | 18 x 1,5 |
| NV10S/10L  | 10    | 18 x 1,5 | 16 x 1,5 |

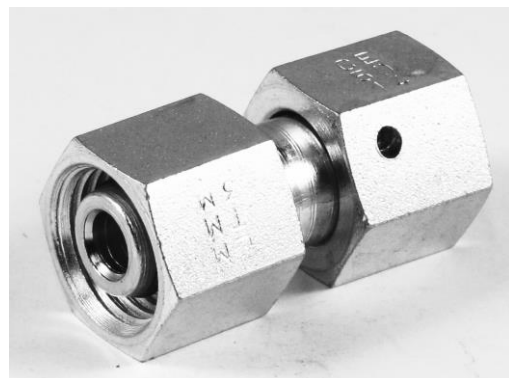

|           |       |          |          |
|-----------|-------|----------|----------|
| NV12S     | 12    | 20 x 1,5 | 20 x 1,5 |
| NV12S/08L | 12/08 | 20 x 1,5 | 14 x 1,5 |
| NV12S/10L | 12/10 | 20x1,5   | 16x1,5   |
| NV12S/12L | 12/12 | 20 x 1,5 | 18 x 1,5 |
| NV12S/08S | 12/08 | 20 x 1,5 | 16 x 1,5 |
| NV12S/10S | 12/10 | 20 x 1,5 | 18 x 1,5 |
| NV14S     | 14    | 22 x 1,5 | 22 x 1,5 |
| NV16S     | 16    | 24 x 1,5 | 24 x 1,5 |
| NV16S/12S | 16/12 | 24 x 1,5 | 20 x 1,5 |
| NV20S     | 20    | 30 x 2,0 | 30 x 2,0 |
| NV20S/16S | 20/16 | 30 x 2,0 | 24 x 1,5 |
| NV20S/18L | 20/18 | 30 x 2,0 | 26 x 1,5 |
| NV25S     | 25    | 36 x 2,0 | 36 x 2,0 |
| NV25S/16S | 25/16 | 36 x 2,0 | 24 x 1,5 |
| NV30S     | 30    | 42 x 2,0 | 42 x 2,0 |
| NV30/20S  | 30/20 | 42 x 2,0 | 30 x 2,0 |
| NV30/25S  | 30/25 | 42 x 2,0 | 36 x 2,0 |
| NV38S     | 38    | 52 x 2,0 | 52 x 2,0 |
| NV38S/30S | 38/30 | 52 x 2,0 | 42 x 2,0 |

\* Standaard verzinkt, ook leverbaar in RVS – standard zingué, aussi livrable en inox

## SNIJRINGKOPPELINGEN / RACCORDS A BAGUE COUPANTE

**KOPPELING 45 ° MET METRISCHE BINNENDRAAD  
RACCORD 45° AVEC FILET INTERIEUR METRIQUE**

| <b>NV45--</b> |         | <b>Metr.</b> | <b>Metr.</b> |
|---------------|---------|--------------|--------------|
| Art.N°        | AD1/AD2 | Ma           | Mb           |
| NV45-12L      | 12      | 18 x 1,5     | 18 x 1,5     |
| NV45-12S      | 12      | 20 x 1,5     | 20 x 1,5     |
| NV45-16S      | 16      | 24 x 1,5     | 24 x 1,5     |
| NV45-20S      | 20      | 30 x 2       | 30 x 2       |
| NV45-25S      | 25      | 36 x2        | 36 x2        |
|               |         |              |              |
|               |         |              |              |
|               |         |              |              |

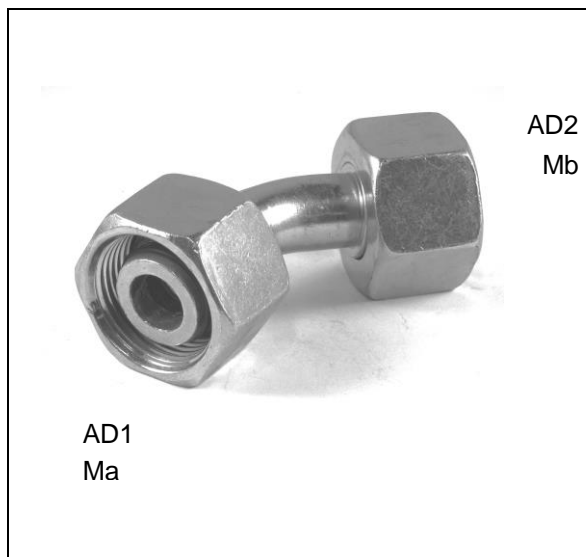

\* Standaard verzinkt, ook leverbaar in RVS – standard zingué, aussi livrable en inox

## SNIJRINGKOPPELINGEN / RACCORDS A BAGUE COUPANTE

**KOPPELING 90 ° MET METRISCHE BINNENDRAAD  
RACCORD 90° AVEC FILET INTERIEUR METRIQUE**

| <b>NV90--</b> |         | <b>Metr.</b> | <b>Metr.</b> |
|---------------|---------|--------------|--------------|
| Art.N°        | AD1/AD2 | Ma           | Mb           |
| NV90-10L      | 10      | 16 x 1,5     | 16 x 1,5     |
| NV90-12L      | 12      | 18 x 1,5     | 18 x 1,5     |
| NV90-15L      | 15      | 22 x 1,5     | 22 x 1,5     |
| NV90-12S      | 12      | 20 x 1,5     | 20 x 1,5     |
| NV90-12S/08L  | 12/08   | 20 x 1,5     | 14 x 1,5     |
|               |         |              |              |
|               |         |              |              |
|               |         |              |              |

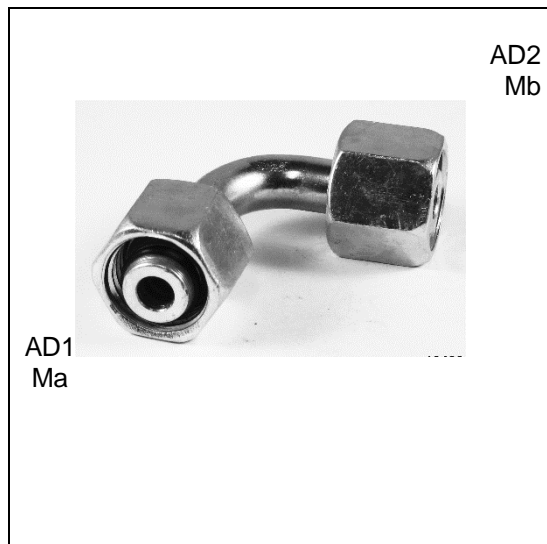

\* Standaard verzinkt, ook leverbaar in RVS – standard zingué, aussi livrable en inox

# SNIJRINGKOPPELINGEN / RACCORDS A BAGUE COUPANTE

## VERVALKOPPELINGEN / REDUCTIONS

### REDV.....L SV

| Art.N°          | d1 | Buitendiameter buis<br>Ø extérieur tube |
|-----------------|----|---|
| REDV 06/10L SV  | 6  | 10                                      |
| REDV 08/06L SV  | 8  | 6                                       |
| REDV 08/10L SV  | 8  | 10                                      |
| REDV 08/12L SV  | 8  | 12                                      |
| REDV 08L/12S SV | 8  | 12                                      |
| REDV 10/06L SV  | 10 | 6                                       |
| REDV 10/08L SV  | 10 | 8                                       |
| REDV 10/12L SV  | 10 | 12                                      |
| REDV 10/15L SV  | 10 | 15                                      |
| REDV 10L/12S SV | 10 | 12                                      |
| REDV 10L/14S SV | 10 | 14                                      |
| REDV 12/06L SV  | 12 | 6                                       |
| REDV 12/08L SV  | 12 | 8                                       |
| REDV 12/10L SV  | 12 | 10                                      |
| REDV 12/15L SV  | 12 | 15                                      |
| REDV 12L/12S SV | 12 | 12                                      |
| REDV 12L/14S SV | 12 | 14                                      |
| REDV 15/06L SV  | 15 | 6                                       |
| REDV 15/08L SV  | 15 | 8                                       |
| REDV 15/10L SV  | 15 | 10                                      |
| REDV 15/12L SV  | 15 | 12                                      |
| REDV 15L/12S SV | 15 | 12                                      |
| REDV 15/18L SV  | 15 | 18                                      |
| REDV 15/22L SV  | 15 | 22                                      |
| REDV 18/06L SV  | 18 | 6                                       |
| REDV 18/08L SV  | 18 | 8                                       |
| REDV 18/10L SV  | 18 | 10                                      |
| REDV 18/12L SV  | 18 | 12                                      |
| REDV 18/15L SV  | 18 | 15                                      |
| REDV 18L/16S    | 18 | 16                                      |

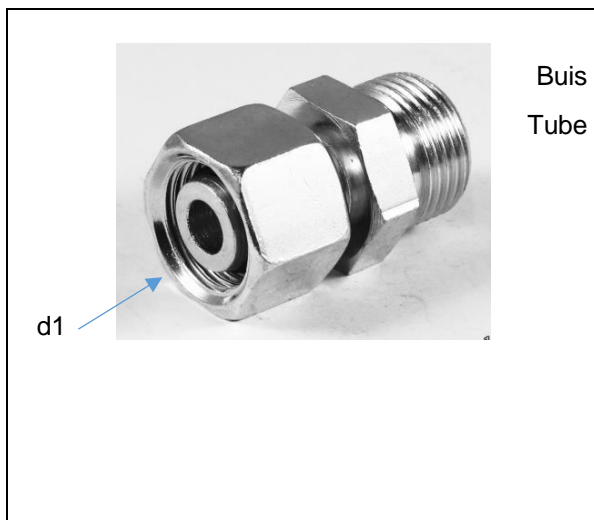

|                 |    |    |
|-----------------|----|----|
| REDV 22/06L SV  | 22 | 6  |
| REDV 22/08L SV  | 22 | 8  |
| REDV 22/10L SV  | 22 | 10 |
| REDV 22/12L SV  | 22 | 12 |
| REDV 22/15L SV  | 22 | 15 |
| REDV 22/18L SV  | 22 | 18 |
| REDV 28/12L SV  | 28 | 12 |
| REDV 28/15L SV  | 28 | 15 |
| REDV 28/18L SV  | 28 | 18 |
| REDV 28/22L SV  | 28 | 22 |
| REDV 28L/30S SV | 28 | 30 |
| REDV 28/42L SV  | 28 | 42 |
| REDV 30/38S SV  | 30 | 38 |
| REDV 35/10L SV  | 35 | 10 |
| REDV 35/12L SV  | 35 | 12 |
| REDV 35/15L SV  | 35 | 15 |
| REDV 35/18L SV  | 35 | 18 |
| REDV 35/22L SV  | 35 | 22 |
| REDV 35/28L SV  | 35 | 28 |
| REDV 42/22L SV  | 42 | 22 |
| REDV 42/28L SV  | 42 | 28 |
| REDV 42/35L SV  | 42 | 35 |

Standaard verzinkt, ook leverbaar in RVS – standard zingué, aussi livrable en inox

## SNIJRINGKOPPELINGEN / RACCORDS A BAGUE COUPANTE

### VERVALKOPPELINGEN / REDUCTIONS

#### REDV.....S SV

| Art.N°          | d1 | Buitendiam. buis<br>Ø extérieur tube |
|-----------------|----|--------------------------------------|
| REDV 08/06S SV  | 08 | 06                                   |
| REDV 10/06S SV  | 10 | 06                                   |
| REDV 10/08S SV  | 10 | 08                                   |
| REDV 10S/12L SV | 10 | 12                                   |
| REDV 10/12S SV  | 10 | 12                                   |
| REDV 12/06S SV  | 12 | 06                                   |
| REDV 12/08S SV  | 12 | 08                                   |
| REDV 12S/10L SV | 12 | 10                                   |
| REDV 12/10S SV  | 12 | 10                                   |
| REDV 12S/15L SV | 12 | 15                                   |
| REDV 14/06S SV  | 14 | 06                                   |
| REDV 14/08S SV  | 14 | 08                                   |
| REDV 14/10S SV  | 14 | 10                                   |
| REDV 14/12S SV  | 14 | 12                                   |
| REDV 16/06S SV  | 16 | 06                                   |
| REDV 16/08S SV  | 16 | 08                                   |
| REDV 16/10S SV  | 16 | 10                                   |
| REDV 16/12S SV  | 16 | 12                                   |
| REDV 16/14S SV  | 16 | 14                                   |
| REDV 20/06S SV  | 20 | 06                                   |
| REDV 20/08S SV  | 20 | 08                                   |
| REDV 20/10S SV  | 20 | 10                                   |
| REDV 20/12S SV  | 20 | 12                                   |
| REDV 20/14S SV  | 20 | 14                                   |
| REDV 20/16S SV  | 20 | 16                                   |
| REDV 25/06S SV  | 25 | 6                                    |
| REDV 25/08S SV  | 25 | 8                                    |
| REDV 25/12S SV  | 25 | 12                                   |

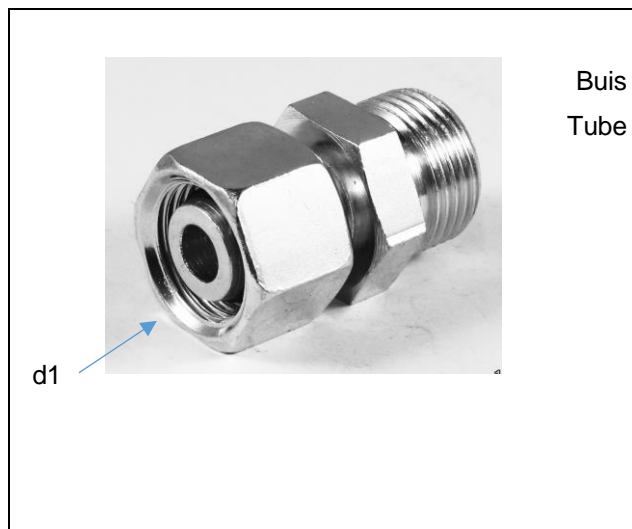

|                |    |    |
|----------------|----|----|
| REDV 25/10S SV | 25 | 10 |
| REDV 25/14S SV | 25 | 14 |
| REDV 25/16S SV | 25 | 16 |
| REDV 25/20S SV | 25 | 20 |
| REDV 30/06S SV | 30 | 6  |
| REDV 30/08S SV | 30 | 8  |
| REDV 30/10S SV | 30 | 10 |
| REDV 30/12S SV | 30 | 12 |
| REDV 30/14S SV | 30 | 14 |
| REDV 30/16S SV | 30 | 16 |
| REDV 30/20S SV | 30 | 20 |
| REDV 30/25S SV | 30 | 25 |
| REDV 38/06S SV | 38 | 6  |
| REDV 38/08S SV | 38 | 8  |
| REDV 38/10S SV | 38 | 10 |
| REDV 38/12S SV | 38 | 12 |
| REDV 38/14S SV | 38 | 14 |
| REDV 38/16S SV | 38 | 16 |
| REDV 38/20S SV | 38 | 20 |
| REDV 38/25S SV | 38 | 25 |
| REDV 38/30S SV | 38 | 30 |

Standaard verzinkt, ook leverbaar in RVS – standard zingué, aussi livrable en inox

# SNIJRINGKOPPELINGEN / RACCORDS A BAGUE COUPANTE

## VERVALKOPPELINGEN 90° / REDUCTIONS 90°

### REDV90..... SV

| Art.N°            | d1  | Buitendiam. Buis<br>Ø extérieur tube |
|-------------------|-----|--------------------------------------|
| REDV90-06L/06S SV | 06L | 06S                                  |
| REDV90-06S/06L SV | 06S | 06L                                  |
| REDV90-08L/08S SV | 08L | 08S                                  |
| REDV90-08S/08L SV | 08S | 08L                                  |
| REDV90-10L/10S SV | 10L | 10S                                  |
| REDV90-10S/10L SV | 10S | 10L                                  |
| REDV90-12L/12S SV | 12L | 12S                                  |
| REDV90-12S/12L SV | 12S | 12L                                  |



d1

Buis - Tube

\* Standaard verzinkt, ook leverbaar in RVS – standard zingué, aussi livrable en inox



## SNIJRINGKOPPELINGEN / RACCORDS A BAGUE COUPANTE

### STEUNRING VOOR BUIS SAE 37° / BAGUE DE RENFORT POUR SAE 37°

| STR    |                                      |      |
|--------|--------------------------------------|------|
| Art.N° | Buitendiam. buis<br>Ø extérieur tube | L    |
| STR 06 | 6                                    | 10,4 |
| STR 08 | 8                                    | 11,2 |
| STR 10 | 10                                   | 12,7 |
| STR 12 | 12                                   | 14,2 |
| STR 14 | 14                                   | 16,8 |
| STR 15 | 15                                   | 16,8 |
| STR 16 | 16                                   | 16,8 |
| STR 18 | 18                                   | 17,3 |
| STR 20 | 20                                   | 17,3 |
| STR 22 | 22                                   | 19,3 |
| STR 25 | 25                                   | 19,8 |
| STR 30 | 30                                   | 23,1 |
| STR 32 | 32                                   | 23,1 |
| STR 38 | 38                                   | 28,4 |
|        |                                      |      |
|        |                                      |      |

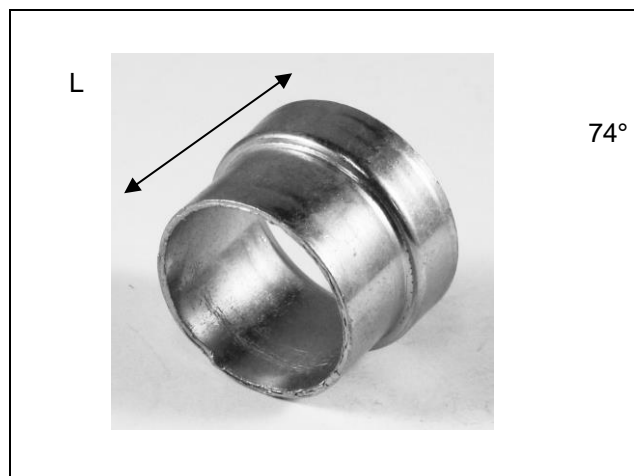

---

---

---

---

---

---

---

---

---

---

\* Standaard verzinkt, ook leverbaar in RVS – standard zingué, aussi livrable en inox

# SNIJRINGKOPPELINGEN / RACCORDS A BAGUE COUPANTE

## SNIJRINGEN / BAGUES COUPANTES

### SR.....

| Art.N°   | Buitendiam. Buis<br>Ø extérieur tube |
|----------|--------------------------------------|
| SR 04LL  | 4                                    |
| SR 05LL  | 5                                    |
| SR 06LL  | 6                                    |
| SR 08LL  | 8                                    |
| SR 10LL  | 10                                   |
| SR 12LL  | 12                                   |
| SR 16LL  | 16                                   |
| SR 06L/S | 6                                    |
| SR 08L/S | 8                                    |
| SR 10L/S | 10                                   |
| SR 12L/S | 12                                   |
| SR 11L   | 11                                   |
| SR 13L   | 13                                   |
| SR 14L   | 14                                   |
| SR 15L   | 15                                   |
| SR 17L   | 17                                   |
| SR 18L   | 18                                   |
| SR 21L   | 21                                   |
| SR 22L   | 22                                   |
| SR 27L   | 27                                   |
| SR 28L   | 28                                   |
| SR 33L   | 33                                   |
| SR 35L   | 35                                   |
| SR 42L   | 42                                   |



|        |    |
|--------|----|
| SR 14S | 14 |
| SR 16S | 16 |
| SR 20S | 20 |
| SR 25S | 25 |
| SR 30S | 30 |
| SR 38S | 38 |
|        |    |
|        |    |
|        |    |
|        |    |
|        |    |
|        |    |
|        |    |
|        |    |

Standaard verzinkt, ook leverbaar in RVS – standard zingué, aussi livrable en inox

## SNIJRINGKOPPELINGEN / RACCORDS A BAGUE COUPANTE

### BANJOKOPPELING MET METRISCHE SCHROEFDRAAD RACCORD BANJO AVEC FILET METRIQUE

#### SWV.....M

| Art.N°          | Buitendiam.<br>buis<br>Ø extérieur<br>tube | M        |
|-----------------|--|----------|
| SWV 04LL M8x1   | 4  | M 8x1    |
| SWV 06LL M10x1  | 6  | M 10x1   |
| SWV 08LL M10x1  | 8  | M 10x1   |
| SWV 06L M10x1   | 6  | M 10x1   |
| SWV 08L M12x1,5 | 8  | M 12x1,5 |
| SWV 10L M14x1,5 | 10   | M 14x1,5 |
| SWV 12L M16x1,5 | 12   | M 16x1,5 |
| SWV 12L M18x1,5 | 12   | M 18x1,5 |
| SWV 15L M18x1,5 | 15   | M 18x1,5 |
| SWV 18L M22x1,5 | 18   | M 22x1,5 |
| SWV 22L M26x1,5 | 22   | M 26x1,5 |
| SWV 28L M33x2   | 28   | M 33x2   |
| SWV 35L M42X2   | 35   | M 42X2   |
| SWV 42L M48X2   | 42   | M 48X2   |
|                 |  |          |
|                 |  |          |

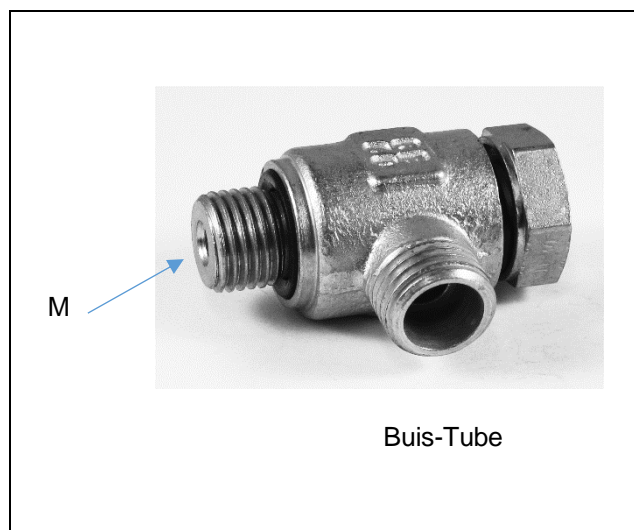

|                 |    |          |
|-----------------|----|----------|
| SWV 06S M12x1,5 | 6  | M 12x1,5 |
| SWV 08S M14x1,5 | 8  | M 14x1,5 |
| SWV 10S M16x1,5 | 10 | M 16x1,5 |
| SWV 12S M18x1,5 | 12 | M 18x1,5 |
| SWV 14S M20x1,5 | 14 | M 20x1,5 |
| SWV 16S M22x1,5 | 16 | M 22x1,5 |
| SWV 20S M27x2   | 20 | M 27x2   |
| SWV 25S M33x2   | 25 | M 33x2   |
| SWV 38S M48x2   | 38 | M 48x2   |

Standaard verzinkt, ook leverbaar in RVS – standard zingué, aussi livrable en inox

## SNIJRINGKOPPELINGEN / RACCORDS A BAGUE COUPANTE

### BANJOKOPPELING MET BSP DRAAD RACCORD BANJO AVEC FILET BSP

#### SWV.....R

Art.N°                      Buitendiam. buis                      G

Ø extérieur tube

|                |    |       |
|----------------|----|-------|
| SWV 04LL R1/8  | 4  | G 1/8 |
| SWV 06LL R1/8  | 6  | G 1/8 |
| SWV 08LL R1/8  | 8  | G 1/8 |
| SWV 06L R1/8   | 6  | G 1/8 |
| SWV 08L R1/4   | 8  | G 1/4 |
| SWV 10L R1/4   | 10 | G 1/4 |
| SWV 10L R3/8   | 10 | G 3/8 |
| SWV 12L R1/4   | 12 | G 1/4 |
| SWV 12L R3/8   | 12 | G 3/8 |
| SWV 12 L R1/2  | 12 | G 1/2 |
| SWV 15L R3/8   | 15 | G 3/8 |
| SWV 15L R1/2   | 15 | G 1/2 |
| SWV 18L R1/2   | 18 | G 1/2 |
| SWV 22L R3/4   | 22 | G 3/4 |
| SWV 28L R1     | 28 | G 1"  |
| SWV 35L R1 1/4 | 35 | G 1"  |

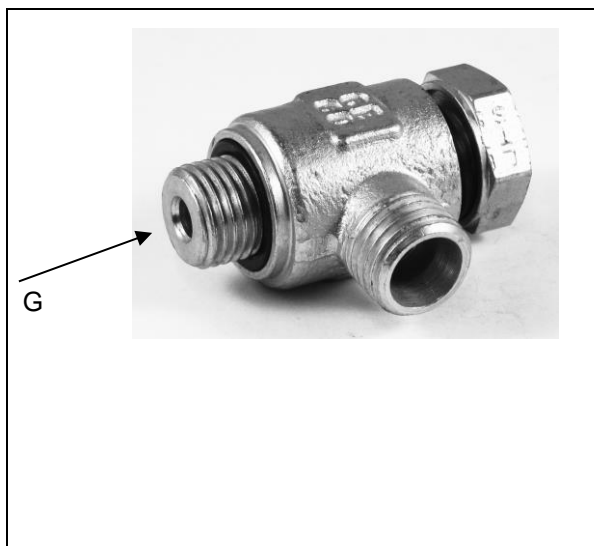

|                 |    |          |
|-----------------|----|----------|
| SWV 06S R1/4    | 6  | G 1/4    |
| SWV 08S R1/4    | 8  | G 1/4    |
| SWV 10S R3/8    | 10 | G 3/8    |
| SWV 12S R3/8    | 12 | G 3/8    |
| SWV 14S R1/2    | 14 | G 1/2    |
| SWV 16S R1/2    | 16 | G 1/2    |
| SWV 20S R3/4    | 20 | G 3/4    |
| SWV 25S R1      | 25 | G 1"     |
| SWV 30S R1" 1/4 | 30 | G 1" 1/4 |
| SWV 38S R1" 1/2 | 38 | G 1" 1/2 |

Standaard verzinkt, ook leverbaar in RVS – standard zingué, aussi livrable en inox

## SNIJRINGKOPPELINGEN / RACCORDS A BAGUE COUPANTE

"T" KOPPELING MET METRISCHE DRAAD  
RACCORD EN "T" AVEC FILET METRIQUE

### TEV.....M

| Art.N°          | Buitendiam.<br>buis<br>Ø extérieur<br>tube | M       |
|-----------------|--|---------|
| TEV 22L M26x1,5 | 22   | M26x1,5 |
| TEV 28L M33x2   | 28   | M33x2   |
| TEV 35L M42x2   | 35   | M42x2   |
| TEV 20S M27x2   | 20   | M27x2   |
| TEV 25S M33x2   | 25   | M33x2   |
| TEV 30S M42x2   | 30   | M42x2   |
| TEV 38S M48x2   | 38   | M48x2   |



M

Standaard verzinkt, ook leverbaar in RVS – standard zingué, aussi livrable en inox

## SNIJRINGKOPPELINGEN / RACCORDS A BAGUE COUPANTE

### "T" KOPPELING MET BSP DRAAD / RACCORD EN "T" AVEC FILET BSP

#### TEV.....R

| Art.N°         | Buitendiam.<br>buis<br>Ø extérieur<br>tube | G       |
|----------------|--|---------|
| TEV 22L R3/4   | 22   | G 3/4   |
| TEV 28L R1     | 28   | G 1"    |
| TEV 35L R1 1/4 | 35   | G 1 1/4 |
| TEV 20S R3/4   | 20   | G 3/4   |
| TEV 25S R1     | 25   | G 1"    |
| TEV 30S R1 1/4 | 30   | G 1 1/4 |
| TEV 38S R1 1/2 | 38   | G 1 1/2 |



\*\*\* ook verkrijgbaar in oriënteerbare versie (TEV ... BMO ...)

\*\*\* aussi livrable en version oriëntable (TEV ... BMO ...)

Standaard verzinkt, ook leverbaar in RVS – standard zingué, aussi livrable en inox

## SNIJRINGKOPPELINGEN / RACCORDS A BAGUE COUPANTE

**“T” KOPPELING MET CONISCHE BSP DRAAD  
RACCORD EN “T” AVEC FILET BSP CONIQUE**

### TEV.....RK

| Art.N°         | Buitendiam. buis<br>Ø extérieur tube | G<br>con. |
|----------------|--------------------------------------|-----------|
| TEV 04LL RK1/8 | 4                                    | G 1/8     |
| TEV 06LL RK1/8 | 6                                    | G 1/8     |
| TEV 08LL RK1/8 | 8                                    | G 1/8     |
| TEV 06L RK1/8  | 6                                    | G 1/8     |
| TEV 08L RK1/4  | 8                                    | G 1/4     |
| TEV 10L RK1/4  | 10                                   | G 1/4     |
| TEV 12L RK3/8  | 12                                   | G 3/8     |
| TEV 15L RK1/2  | 15                                   | G 1/2     |
| TEV 18L RK1/2  | 18                                   | G 1/2     |
|                |                                      |           |
|                |                                      |           |
|                |                                      |           |
|                |                                      |           |
|                |                                      |           |
|                |                                      |           |
|                |                                      |           |
|                |                                      |           |



G con.

|               |    |       |
|---------------|----|-------|
| TEV 06S RK1/4 | 6  | G 1/4 |
| TEV 08S RK1/4 | 8  | G 1/4 |
| TEV 10S RK3/8 | 10 | G 3/8 |
| TEV 12S RK3/8 | 12 | G 3/8 |
| TEV 14S RK1/2 | 14 | G 1/2 |
| TEV 16S RK1/2 | 16 | G 1/2 |
| TEV 20S RK3/4 | 20 | G 3/4 |

Standaard verzinkt, ook leverbaar in RVS – standard zingué, aussi livrable en inox

## SNIJRINGKOPPELINGEN / RACCORDS A BAGUE COUPANTE

### "T" VERBINDING / UNION EN "T"

#### TV.....

| Art.N°  | Buitendiam. Buis<br>Ø extérieur tube |
|---------|--------------------------------------|
| TV 04LL | 4                                    |
| TV 06LL | 6                                    |
| TV 08LL | 8                                    |
| TV 06L  | 6                                    |
| TV 08L  | 8                                    |
| TV 10L  | 10                                   |
| TV 12L  | 12                                   |
| TV 13L  | 13                                   |
| TV 15L  | 15                                   |
| TV 17L  | 17                                   |
| TV 18L  | 18                                   |
| TV 21L  | 21                                   |
| TV 22L  | 22                                   |
| TV 27L  | 27                                   |
| TV 28L  | 28                                   |
| TV 33L  | 33                                   |
| TV 35L  | 35                                   |
| TV 42L  | 42                                   |
|         |                                      |
|         |                                      |



|        |    |
|--------|----|
| TV 06S | 6  |
| TV 08S | 8  |
| TV 10S | 10 |
| TV 12S | 12 |
| TV 14S | 14 |
| TV 16S | 16 |
| TV 20S | 20 |
| TV 25S | 25 |
| TV 30S | 30 |
| TV 38S | 38 |
|        |    |
|        |    |

Standaard verzinkt, ook leverbaar in RVS – standard zingué, aussi livrable en inox



## SNIJRINGKOPPELINGEN / RACCORDS A BAGUE COUPANTE

STOP VOOR CONE 24° / BOUCHON CÔNE 24°

### VS.....

| Art.N°   | Buitendiam. buis<br>Ø extérieur tube |
|----------|--------------------------------------|
| VS 06L/S | 6                                    |
| VS 08L/S | 8                                    |
| VS 10L/S | 10                                   |
| VS 12L/S | 12                                   |
| VS 13L   | 13                                   |
| VS 15L   | 15                                   |
| VS 17L   | 17                                   |
| VS 18L   | 18                                   |
| VS 21L   | 21                                   |
| VS 22L   | 22                                   |
| VS 27L   | 27                                   |
| VS 28L   | 28                                   |
| VS 33L   | 33                                   |
| VS 35L   | 35                                   |
| VS 42L   | 42                                   |
|          |                                      |
|          |                                      |
|          |                                      |



|        |    |
|--------|----|
| VS 14S | 14 |
| VS 16S | 16 |
| VS 20S | 20 |
| VS 25S | 25 |
| VS 30S | 30 |
| VS 38S | 38 |
|        |    |
|        |    |
|        |    |

Standaard verzinkt, ook leverbaar in RVS – standard zingué, aussi livrable en inox

## SNIJRINGKOPPELINGEN / RACCORDS A BAGUE COUPANTE

STOP MET BSP DRAAD / BOUCHON AVEC FILET BSP

### VS R.....

| Art.N°     | Zeskant<br>Hexagone | G       |
|------------|---------------------|---------|
| VS R 1/8   | 5                   | G 1/8   |
| VS R 1/4   | 6                   | G 1/4   |
| VS R 3/8   | 8                   | G 3/8   |
| VS R 1/2   | 10                  | G 1/2   |
| VS R 3/4   | 12                  | G 3/4   |
| VS R 1     | 17                  | G 1     |
| VS R 1 1/4 | 22                  | G 1 1/4 |
| VS R 1 1/2 | 24                  | G 1 1/2 |
|            |                     |         |
|            |                     |         |
|            |                     |         |
|            |                     |         |
|            |                     |         |

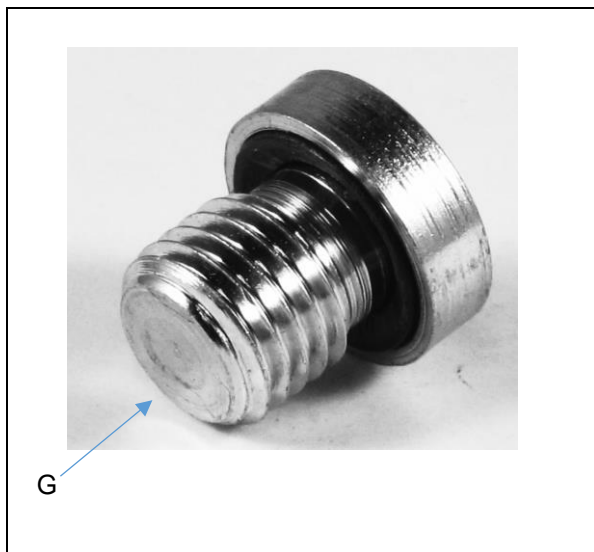

Standaard verzinkt, ook leverbaar in RVS – standard zingué, aussi livrable en inox

## SNIJRINGKOPPELINGEN / RACCORDS A BAGUE COUPANTE

**STOP MET METRISCHE DRAAD  
BOUCHON AVEC FILET METRIQUE**

### VS M.....

| Art.N°     | Zeskant<br>Hexagone | M        |
|------------|---------------------|----------|
| VS M10x1   | 5                   | M 10x1   |
| VS M12x1,5 | 6                   | M 12x1,5 |
| VS M14x1,5 | 6                   | M 14x1,5 |
| VS M16x1,5 | 8                   | M 16x1,5 |
| VS M18x1,5 | 8                   | M 18x1,5 |
| VS M20x1,5 | 10                  | M 20x1,5 |
| VS M22x1,5 | 10                  | M 22x1,5 |
| VS M26x1,5 | 12                  | M 26x1,5 |
| VS M27x2   | 12                  | M 27x2   |
| VS M33x2   | 17                  | M 33x2   |

### V--.....

| Art.N° | Buitendiam. buis<br>Ø extérieur tube | M        |
|--------|--------------------------------------|----------|
| VL 06  | 06                                   | M 12x1,5 |
| VL 08  | 08                                   | M 14x1,5 |
| VL 10  | 10                                   | M 16x1,5 |
| VL 12  | 12                                   | M 18x1,5 |
| VL 15  | 15                                   | M 22x1,5 |
| VL 18  | 18                                   | M 26x1,5 |
| VL 22  | 22                                   | M 30x2   |
| VL 28  | 28                                   | M 36x2   |
| VL 35  | 35                                   | M 45x2   |
| VL 42  | 42                                   | M 52x2   |
| VS 06  | 06                                   | M 14x1,5 |
| VS 08  | 08                                   | M 16x1,5 |
| VS 10  | 10                                   | M 18x1,5 |
| VS 12  | 12                                   | M 20x1,5 |

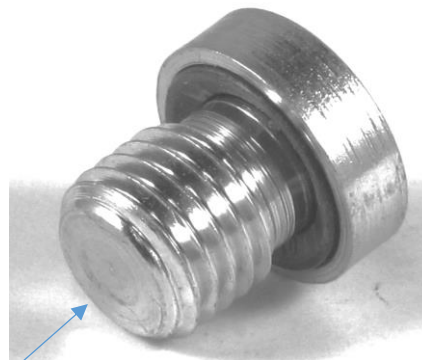

M

|          |    |        |
|----------|----|--------|
| VS M42x2 | 22 | M 42x2 |
| VS M48x2 | 24 | M 48x2 |

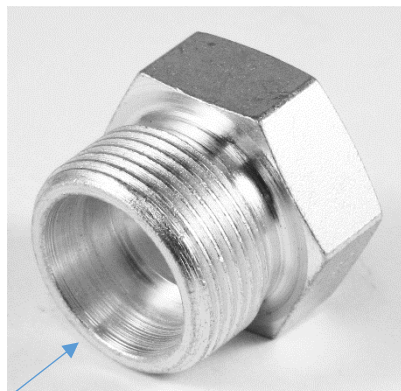

M

|       |    |          |
|-------|----|----------|
| VS 14 | 14 | M 22x1,5 |
| VS 16 | 16 | M 24x1,5 |
| VS 20 | 20 | M 30x2   |
| VS 25 | 25 | M 36x2   |
| VS 30 | 30 | M 42x2   |
| VS 38 | 38 | M 52x2   |

Standaard verzinkt, ook leverbaar in RVS – standard zingué, aussi livrable en inox

## SNIJRINGKOPPELINGEN / RACCORDS A BAGUE COUPANTE

### KOPPELING 90° CONISCHE METRISCHE DRAAD RACCORD 9° AVEC FILET METRIQUE CONIQUE

#### WEV.....MK

| Art.N°           | Buitendiam. buis<br>Ø extérieur tube | Metr.con. |
|------------------|--------------------------------------|-----------|
| WEV 04LL MK6x1   | 4                                    | M6x1      |
| WEV 04LL MK8x1   | 4                                    | M8x1      |
| WEV 04LL MK10x1  | 4                                    | M10x1     |
| WEV 05LL MK8x1   | 5                                    | M8x1      |
| WEV 06LL MK6x1   | 6                                    | M6x1      |
| WEV 06LL MK8x1   | 6                                    | M8x1      |
| WEV 06LL MK10x1  | 6                                    | M10x1     |
| WEV 06L MK10x1   | 6                                    | M10x1     |
| WEV 08L MK12x1,5 | 8                                    | M12x1,5   |
| WEV 10L MK14x1,5 | 10                                   | M14x1,5   |
| WEV 12L MK16x1,5 | 12                                   | M16x1,5   |
| WEV 15L MK18x1,5 | 15                                   | M18x1,5   |
| WEV 18L MK22x1,5 | 18                                   | M22x1,5   |
|                  |                                      |           |
|                  |                                      |           |
|                  |                                      |           |
|                  |                                      |           |
|                  |                                      |           |
|                  |                                      |           |



|                  |    |         |
|------------------|----|---------|
| WEV 08S MK14x1,5 | 8  | M14x1,5 |
| WEV 10S MK16x1,5 | 10 | M16x1,5 |
| WEV 12S MK18x1,5 | 12 | M18x1,5 |
| WEV 14S MK20x1,5 | 14 | M20x1,5 |
| WEV 16S MK22x1,5 | 16 | M22x1,5 |
|                  |    |         |
|                  |    |         |
|                  |    |         |
|                  |    |         |

Standaard verzinkt, ook leverbaar in RVS – standard zingué, aussi livrable en inox

## SNIJRINGKOPPELINGEN / RACCORDS A BAGUE COUPANTE

### KOPPELING 90° MET NPT DRAAD RACCORD 90° AVEC FILET NPT

#### WEV.....NPT

| Art.N°           | Buitendiam.<br>buis<br>Ø extérieur<br>tube | NPT     |
|------------------|--|---------|
| WEV 04LL 1/8NPT  | 4  | 1/8 NPT |
| WEV 06LL 1/8NPT  | 6  | 1/8 NPT |
| WEV 08LL 1/8NPT  | 8  | 1/8 NPT |
| WEV 06L 1/8NPT   | 6  | 1/8 NPT |
| WEV 06L 1/4NPT   | 6  | 1/4 NPT |
| WEV 08L 1/8NPT   | 8  | 1/8 NPT |
| WEV 08L 1/4NPT   | 8  | 1/4 NPT |
| WEV 08L 3/8NPT   | 8  | 3/8 NPT |
| WEV 10L 1/4NPT   | 10   | 1/4 NPT |
| WEV 10L 3/8NPT   | 10   | 3/8 NPT |
| WEV 12L 1/4NPT   | 12   | 1/4 NPT |
| WEV 12L 3/8NPT   | 12   | 3/8 NPT |
| WEV 12L 1/2NPT   | 12   | 1/2 NPT |
| WEV 15L 3/8NPT   | 15   | 3/8 NPT |
| WEV 15L 1/2NPT   | 15   | 1/2 NPT |
| WEV 18L 1/2NPT   | 18   | 1/2 NPT |
| WEV 18L 3/4NPT   | 18   | 3/4 NPT |
| WEV 22L 3/4NPT   | 22   | 3/4 NPT |
| WEV 28L 1NPT     | 28   | 1 NPT   |
| WEV 35L 1 1/4NPT | 35   | 1 1/4   |
| WEV 42L 1 1/2NPT | 42   | 1 1/2   |
|                  |  |         |
|                  |  |         |



NPT

|                  |    |           |
|------------------|----|-----------|
| WEV 06S 1/4NPT   | 6  | 1/4 NPT   |
| WEV 08S 1/4NPT   | 8  | 1/4 NPT   |
| WEV 10S 3/8NPT   | 10 | 3/8 NPT   |
| WEV 12S 3/8NPT   | 12 | 3/8 NPT   |
| WEV 12S 1/2NPT   | 12 | 1/2 NPT   |
| WEV 14S 3/8NPT   | 14 | 3/8 NPT   |
| WEV 14S 1/2NPT   | 14 | 1/2 NPT   |
| WEV 16S 3/8NPT   | 16 | 3/8 NPT   |
| WEV 16S 1/2NPT   | 16 | 1/2 NPT   |
| WEV 20S 1/2NPT   | 20 | 1/2 NPT   |
| WEV 20S 3/4NPT   | 20 | 3/4 NPT   |
| WEV 25S 3/4NPT   | 25 | 3/4 NPT   |
| WEV 25S 1NPT     | 25 | 1 NPT     |
| WEV 30S 1 1/4NPT | 30 | 1 1/4 NPT |
| WEV 38S 1 1/2NPT | 38 | 1 1/2 NPT |

Standaard verzinkt, ook leverbaar in RVS – standard zingué, aussi livrable en inox

## SNIJRINGKOPPELINGEN / RACCORDS A BAGUE COUPANTE

### KOPPELING 90° BSP CONISCHE DRAAD RACCORD 90° AVEC FILET BSP CONIQUE

#### WEV.....RK

| Art.N°          | Buitendiam. buis<br>Ø extérieur tube | G-con. |
|-----------------|--------------------------------------|--------|
| WEV 04LL RK1/8  | 4                                    | G 1/8  |
| WEV 05 LL RK1/8 | 5                                    | G 1/8  |
| WEV 06LL RK1/8  | 6                                    | G 1/8  |
| WEV 08LL RK1/8  | 8                                    | G 1/8  |
|                 |                                      |        |
| WEV 06L RK1/8   | 6                                    | G 1/8  |
| WEV 06L RK1/4   | 6                                    | G 1/4  |
| WEV 06L RK3/8   | 6                                    | G 3/8  |
| WEV 08L RK1/8   | 8                                    | G 1/8  |
| WEV 08L RK1/4   | 8                                    | G 1/4  |
| WEV 08L RK3/8   | 8                                    | G 3/8  |
| WEV 10L RK1/8   | 10                                   | G 1/8  |
| WEV 10L RK1/4   | 10                                   | G 1/4  |
| WEV 10L RK3/8   | 10                                   | G 3/8  |
| WEV 12L RK1/4   | 12                                   | G 1/4  |
| WEV 12L RK3/8   | 12                                   | G 3/8  |
| WEV 12L RK1/2   | 12                                   | G 1/2  |
| WEV 13L RK1/4   | 13                                   | G 1/4  |
| WEV 13L RK3/8   | 13                                   | G 3/8  |
| WEV 13L RK1/2   | 13                                   | G 1/2  |
| WEV 15L RK3/8   | 15                                   | G 3/8  |
| WEV 15L RK1/2   | 15                                   | G 1/2  |
| WEV 17L RK1/4   | 17                                   | G 1/4  |
| WEV 17L RK3/8   | 17                                   | G 3/8  |
| WEV 17L RK1/2   | 17                                   | G 1/2  |
| WEV 18L RK1/2   | 18                                   | G 1/2  |
| WEV 18L RK3/4   | 18                                   | G 3/4  |
| WEV 21L RK1/2   | 21                                   | G 1/2  |
| WEV 21L RK3/4   | 21                                   | G 3/4  |
| WEV 22L RK3/4   | 22                                   | G 3/4  |



G con.

|                 |    |          |
|-----------------|----|----------|
| WEV 27L RK3/4   | 27 | G 3/4    |
| WEV 27L RK1     | 27 | G 1"     |
| WEV 33L RK1     | 33 | G 1"     |
| WEV 33L RK1 1/4 | 33 | G 1" 1/4 |
|                 |    |          |
| WEV 06S RK1/4   | 6  | G 1/4    |
| WEV 08S RK1/4   | 8  | G 1/4    |
| WEV 10S RK3/8   | 10 | G 3/8    |
| WEV 12S RK3/8   | 12 | G 3/8    |
| WEV 12 S RK1/2  | 12 | G 1/2    |
| WEV 14S RK3/8   | 14 | G 3/8    |
| WEV 14S RK1/2   | 14 | G 1/2    |
| WEV 16S RK3/8   | 16 | G 3/8    |
| WEV 16S RK1/2   | 16 | G 1/2    |
| WEV 20S RK3/4   | 20 | G 3/4    |
| WEV 25S RK1"    | 25 | G 1"     |

Standaard verzinkt, ook leverbaar in RVS – standard zingué, aussi livrable en inox

## SNIJRINGKOPPELINGEN / RACCORDS A BAGUE COUPANTE

### REGELBARE KOPPELING 90° MET BSP DRAAD RACCORD REGLABLE 90° AVEC FILET BSP

#### NWEV.....BMO

| Art.N°          | Buitendiam. buis<br>Ø extérieur tube | G.    |
|-----------------|--------------------------------------|-------|
| WEV 06L BMO 1/8 | 6                                    | G 1/8 |
| WEV 08L BMO 1/4 | 8                                    | G 1/4 |
| WEV 10L BMO 1/4 | 10                                   | G 1/4 |
| WEV 12L BMO 3/8 | 12                                   | G 3/8 |
| WEV 15L BMO 1/2 | 15                                   | G 1/2 |
| WEV 18L BMO 1/2 | 18                                   | G 1/2 |
| WEV 22L BMO 3/4 | 22                                   | G 3/4 |
| WEV 28L BMO 1   | 28                                   | G 1   |
| WEV 35L BMO 1 ¼ | 35                                   | G 1 ¼ |
| WEV 42L BMO 1 ½ | 42                                   | G 1 ½ |
|                 |                                      |       |
|                 |                                      |       |
|                 |                                      |       |
|                 |                                      |       |
|                 |                                      |       |
|                 |                                      |       |
|                 |                                      |       |
|                 |                                      |       |
|                 |                                      |       |
|                 |                                      |       |
|                 |                                      |       |
|                 |                                      |       |
|                 |                                      |       |
|                 |                                      |       |



|                 |    |       |
|-----------------|----|-------|
| WEV 06S BMO 1/4 | 6  | G 1/4 |
| WEV 08S BMO 1/4 | 8  | G 1/4 |
| WEV 10S BMO 3/8 | 10 | G 3/8 |
| WEV 12S BMO 3/8 | 12 | G 3/8 |
| WEV 14S BMO 1/2 | 14 | G 1/2 |
| WEV 16S BMO 1/2 | 16 | G 1/2 |
| WEV 20S BMO 3/4 | 20 | G 3/4 |
| WEV 25S BMO 1   | 25 | G 1   |
| WEV 30S BMO 1 ¼ | 30 | G 1 ¼ |
| WEV 38S BMO 1 ½ | 38 | G 1 ½ |

\* Standaard verzinkt, ook leverbaar in RVS – standard zingué, aussi livrable en inox

## SNIJRINGKOPPELINGEN / RACCORDS A BAGUE COUPANTE

### REGELBARE KOPPELING 90° METRISCHE DRAAD RACCORD REGLABLE 90° AVEC FILET METRIQUE

#### WEV.....MMO

| Art.N°             | Buitendiam. buis<br>Ø extérieur tube | M.      |
|--------------------|--------------------------------------|---------|
| WEV 06L MMO 10x1   | 6                                    | M10x1.0 |
| WEV 08L MMO 12x1.5 | 8                                    | M12x1.5 |
| WEV 10L MMO 14x1.5 | 10                                   | M14x1.5 |
| WEV 12L MMO 16x1.5 | 12                                   | M16x1.5 |
| WEV 15L MMO 18x1.5 | 15                                   | M18x1.5 |
| WEV 18L MMO 22x1.5 | 18                                   | M22x1.5 |
| WEV 22L MMO 27x2   | 27                                   | M27x2.0 |
| WEV 28L MMO 33x2   | 28                                   | M28x2.0 |
| WEV 35L MMO 42x2   | 35                                   | M42x2.0 |
| WEV 42L MMO 48x2   | 42                                   | M48x2.0 |



|                    |    |         |
|--------------------|----|---------|
| WEV 06S MMO 12x1.5 | 6  | M12x1.5 |
| WEV 08S MMO 14x1.5 | 8  | M14x1.5 |
| WEV 10S MMO 16x1.5 | 10 | M16x1.5 |
| WEV 12S MMO 18x1.5 | 12 | M18x1.5 |
| WEV 14S MMO 20x1.5 | 14 | M20x1.5 |
| WEV 16S MMO 22x1.5 | 16 | M22x1.5 |
| WEV 20S MMO 27x2   | 20 | M27x2.0 |
| WEV 25S MMO 33x2   | 25 | M33x2.0 |
| WEV 30S MMO 42x2   | 30 | M42x2.0 |
| WEV 38S MMO 48x2   | 38 | M48x2.0 |

\* Standaard verzinkt, ook leverbaar in RVS – standard zingué, aussi livrable en inox



## SNIJRINGKOPPELINGEN / RACCORDS A BAGUE COUPANTE

### KOPPELING MET SCHOTDOORVOER 90° RACCORD 90° PASSE-CLOISON

#### WSV.....

| Art.N°  | Buitendiam.<br>buis<br>Ø extérieur<br>tube | D<br>min | D<br>max | M       |
|---------|--|----------|----------|---------|
| WSV 06L | 6  | 4        | 16       | M12x1,5 |
| WSV 08L | 8  | 4        | 16       | M14x1,5 |
| WSV 10L | 10   | 4        | 16       | M16x1,5 |
| WSV 12L | 12   | 4        | 16       | M18x1,5 |
| WSV 15L | 15   | 4        | 16       | M22x1,5 |
| WSV 18L | 18   | 4        | 16       | M26x1,5 |
| WSV 22L | 22   | 5        | 16       | M30x2   |
| WSV 28L | 28   | 5        | 16       | M36x2   |
| WSV 35L | 35   | 5        | 16       | M45x2   |
| WSV 42L | 42   | 5        | 16       | M52x2   |
| WSV 06S | 6  | 4        | 16       | M14x1,5 |
| WSV 08S | 8  | 4        | 16       | M16x1,5 |
| WSV 10S | 10   | 4        | 16       | M18x1,5 |
| WSV 12S | 12   | 4        | 16       | M20x1,5 |
| WSV 14S | 14   | 4        | 16       | M22x1,5 |

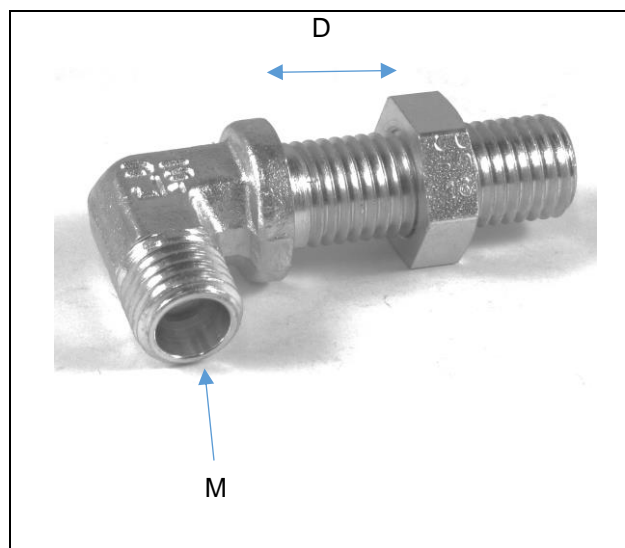

|         |    |   |    |         |
|---------|----|---|----|---------|
| WSV 16S | 16 | 4 | 16 | M24x1,5 |
| WSV 20S | 20 | 5 | 16 | M30x2   |
| WSV 25S | 25 | 5 | 16 | M36x2   |
| WSV 30S | 30 | 5 | 16 | M42x2   |
| WSV 38S | 38 | 5 | 16 | M52x2   |
|         |    |   |    |         |
|         |    |   |    |         |
|         |    |   |    |         |

#### KM- MOER voor schotdoorvoer ECROU pour passe-cloison

| Art.N°      | Draad mm<br>Filet mm |
|-------------|----------------------|
| KM 12 x 1,5 | 12 x 1,5             |
| KM 14 x 1,5 | 14 x 1,5             |
| KM 16 x 1,5 | 16 x 1,5             |
| KM 18 x 1,5 | 18 x 1,5             |
| KM 20 x 1,5 | 20 x 1,5             |
| KM 22 x 1,5 | 22 x 1,5             |
| KM 24 x 1,5 | 24 x 1,5             |
| KM 26 x 1,5 | 26 x 1,5             |



|           |        |
|-----------|--------|
| KM 30 x 2 | 30 x 2 |
| KM 36 x 2 | 36 x 2 |
| KM 52X2   | 52 x 2 |

Standaard verzinkt, ook leverbaar in RVS – standard zingué, aussi livrable en inox

## SNIJRINGKOPPELINGEN / RACCORDS A BAGUE COUPANTE

### KOPPELING 90° / UNION 90°

#### WV.....

Art.N°                      Buitendiam. buis  
Ø extérieur tube

|         |    |
|---------|----|
| WV 04LL | 4  |
| WV 05LL | 5  |
| WV 06LL | 6  |
| WV 08LL | 8  |
| WV 10LL | 10 |
| WV 12LL | 12 |

|           |     |
|-----------|-----|
| WV 06L    | 6   |
| WV 08L    | 8   |
| WV 08/06L | 8-6 |
| WV 10L    | 10  |
| WV 12L    | 12  |
| WV 13L    | 13  |
| WV 15L    | 15  |
| WV 17L    | 17  |
| WV 18L    | 18  |
| WV 21L    | 21  |
| WV 22L    | 22  |
| WV 27L    | 27  |
| WV 28L    | 28  |
| WV 33L    | 33  |
| WV 35L    | 35  |
| WV 42L    | 42  |



|        |    |
|--------|----|
| WV 06S | 6  |
| WV 08S | 8  |
| WV 10S | 10 |
| WV 12S | 12 |
| WV 14S | 14 |
| WV 16S | 16 |
| WV 20S | 20 |
| WV 25S | 25 |
| WV 30S | 30 |
| WV 38S | 38 |

Standaard verzinkt, ook leverbaar in RVS – standard zingué, aussi livrable en inox